

LEASE

11 WEST 42 LIMITED PARTNERSHIP

a New York Limited Partnership

Landlord

and

SPRINGER PUBLISHING COMPANY, INC.,

a New York corporation

Tenant

for

**11 West 42nd Street
New York, New York**

April __, 2004

TABLE OF CONTENTS

ARTICLE 1 BASIC LEASE PROVISIONS	1
ARTICLE 2 PREMISES, TERM, RENT	7
ARTICLE 3 USE AND OCCUPANCY	10
ARTICLE 4 CONDITION OF THE PREMISES	10
ARTICLE 5 ALTERATIONS	11
ARTICLE 6 REPAIRS	11
ARTICLE 7 INCREASES IN TAXES AND OPERATING EXPENSES	11
ARTICLE 8 REQUIREMENTS OF LAW	11
ARTICLE 9 SUBORDINATION	11
ARTICLE 10 SERVICES	11
ARTICLE 11 INSURANCE; PROPERTY LOSS OR DAMAGE	11
ARTICLE 12 EMINENT DOMAIN	11
ARTICLE 13 ASSIGNMENT AND SUBLETTING	11
ARTICLE 14 ACCESS TO PREMISES	11
ARTICLE 15 DEFAULT	11
ARTICLE 16 LANDLORD'S RIGHT TO CURE; FEES AND EXPENSES	11
ARTICLE 17 NO REPRESENTATIONS BY LANDLORD; LANDLORD'S APPROVAL	11
ARTICLE 18 END OF TERM	11
ARTICLE 19 QUIET ENJOYMENT	11
ARTICLE 20 NO SURRENDER; NO WAIVER	11
ARTICLE 21 WAIVER OF TRIAL BY JURY; COUNTERCLAIM	11
ARTICLE 22 NOTICES	11
ARTICLE 23 RULES AND REGULATIONS	11
ARTICLE 24 BROKER	11
ARTICLE 25 INDEMNITY	11
ARTICLE 26 MISCELLANEOUS	11
ARTICLE 27 SUBSTITUTE SPACE	11
ARTICLE 28 RENEWAL TERM	11

Schedule of Exhibits

Exhibit A	Floor Plan
Exhibit B	Definitions
Exhibit C	Workletter
Exhibit D	Design Standards
Exhibit E	Cleaning Specifications
Exhibit F	Rules and Regulations

LEASE

THIS LEASE is made as of the ____ day of April, 2004 ("**Effective Date**"), between **11 WEST 42 LIMITED PARTNERSHIP** ("**Landlord**"), a New York limited partnership, and **SPRINGER PUBLISHING COMPANY, INC.** ("**Tenant**"), a New York corporation.

Landlord and Tenant hereby agree as follows:

ARTICLE 1

BASIC LEASE PROVISIONS

PREMISES	A portion of the fifteenth floor of the Building, as more particularly shown on Exhibit A.
BUILDING	The building, fixtures, equipment and other improvements and appurtenances now located or hereafter erected, located or placed upon the land known as 11 West 42nd Street New York, New York.
REAL PROPERTY	The Building, together with the plot of land upon which it stands.
COMMENCEMENT DATE	The date which is earlier to occur of (a) the date upon which Landlord's Work shall be Substantially Completed in accordance with the terms of this Lease, and (b) the date Tenant (or any person or entity claiming by, through or under Tenant) occupies any part of the Premises for the conduct of its business.
RENT COMMENCEMENT DATE	The date which is 60 days after the Commencement Date.
EXPIRATION DATE	The date which is the last day of the month in which the seventh anniversary of the Rent Commencement Date occurs, or the last day of any renewal or extended term, if the Term of this Lease is extended in accordance with any express provision hereof.
TERM	The period commencing on the Commencement Date and ending on the Expiration Date.
PERMITTED USES	Executive and general offices.
BASE TAX YEARS	The Tax Year commencing on July 1, 2003 and ending on June 30, 2004 and the Tax Year commencing on July 1, 2004 and ending on June 30, 2005.
BASE EXPENSE YEAR	Calendar year 2004.

TENANT'S PROPORTIONATE SHARE	In respect of Taxes, 0.8511 percent and, in respect of Operating Expenses, 0.8818 percent.
AGREED AREA OF BUILDING	In respect of Taxes, 931,240 rentable square feet, and, in respect of Operating Expenses, 898,888 rentable square feet, each as mutually agreed by Landlord and Tenant.
AGREED AREA OF PREMISES	7,926 rentable square feet, as mutually agreed by Landlord and Tenant.
FIXED RENT	(i) \$317,040 per annum (\$26,420 per month) for the period commencing on the Rent Commencement Date and ending on the day preceding the three year six month anniversary of the Rent Commencement Date, both dates inclusive; and (ii) \$348,744 per annum (\$29,060 per month) for the period commencing on the three year six month anniversary of the Rent Commencement Date and ending on the Expiration Date, both dates inclusive.
ADDITIONAL RENT	All sums other than Fixed Rent payable by Tenant to Landlord under this Lease, including Tenant's Tax Payment, Tenant's Operating Payment, late charges, overtime or excess service charges, damages, and interest and other costs related to Tenant's failure to perform any of its obligations under this Lease.
RENT	Fixed Rent and Additional Rent, collectively.
INTEREST RATE	The lesser of (i) 4% per annum above the then-current Base Rate, and (ii) the maximum rate permitted by applicable law.
ELECTRICAL INCLUSION FACTOR	\$23,778.
TENANT'S ADDRESS FOR NOTICES	Until Tenant commences business operations from the Premises: Springer Publishing Company, Inc. 536 Broadway, 11th Floor New York, New York 10012 Attn: Ms. Ursula Springer Mr. Matthew Fenton Ms. Sheri Sussman Mr. Matthew D. Castagna

hereafter:

Springer Publishing Company, Inc.
11 West 42nd Street
New York, New York 10036
Attn: Ms. Ursula Springer
Mr. Matthew Fenton
Ms. Sheri Sussman
Mr. Matthew D. Castagna

with copy, in the case of notice of default, to:

Coudert Brothers LLP
1114 Avenue of the Americas
New York, New York 10036-7703
Attn: Gerard V. Hannon, Esq.

**LANDLORD'S ADDRESS
FOR NOTICES**

11 West 42 Limited Partnership
c/o Tishman Speyer Properties, L.P.
520 Madison Avenue
New York, New York 10022
Attn: Chief Financial Officer

Copies to:

11 West 42 Limited Partnership
c/o Tishman Speyer Properties, L.P.
11 West 42nd Street
New York, New York 10036
Attn: Property Manager

and:

Tishman Speyer Properties, L.P.
520 Madison Avenue
New York, New York 10022
Attn: Chief Legal Officer

TENANT'S BROKER

None.

LANDLORD'S AGENT

Tishman Speyer Properties, L.P. or any other person or entity designated at any time and from time to time by Landlord as Landlord's Agent.

GUARANTOR

Mannheim Holdings LLC.

All capitalized terms used in this Lease without definition are defined in Exhibit B.

ARTICLE 2

PREMISES, TERM, RENT

Section 2.1 Lease of Premises. Subject to the terms of this Lease, Landlord leases to Tenant and Tenant leases from Landlord the Premises for the Term. In addition, Landlord grants to Tenant the right to use, on a non-exclusive basis and in common with other tenants, the Common Areas.

Section 2.2 Commencement Date. Upon the Effective Date, the terms and provisions hereof shall be fully binding on Landlord and Tenant prior to the occurrence of the Commencement Date. The Term of this Lease shall commence on the Commencement Date and, unless sooner terminated or extended as hereinafter provided, shall end on the Expiration Date. If Landlord does not tender possession of the Premises to Tenant on or before any specified date, for any reason whatsoever, Landlord shall not be liable for any damage thereby, this Lease shall not be void or voidable thereby, and the Term shall not commence until Landlord tenders possession of the Premises to Tenant. Landlord shall be deemed to have tendered possession of the Premises to Tenant upon the giving of notice by Landlord to Tenant stating that the Premises are vacant, in the condition required by this Lease and available for Tenant's occupancy and such notice is factually correct. No failure to tender possession of the Premises to Tenant on or before any specified date shall affect any other obligations of Tenant hereunder. There shall be no postponement of the Commencement Date (or the Rent Commencement Date) for (i) any delay in the delivery of possession of the Premises which results from any Tenant Delay or (ii) any delay by Landlord in the performance of any Punch List Items relating to Landlord's Work. Once the Commencement Date is determined, Landlord and Tenant shall execute an agreement stating the Commencement Date, Rent Commencement Date and Expiration Date, but the failure to do so will not affect the determination of such dates. For purposes of determining whether Tenant has accepted possession of the Premises, Tenant shall be deemed to have done so when Tenant first moves Tenant's Property and/or any of its personnel into the Premises and/or commences construction, except to the extent that Tenant is authorized in this Lease or by Landlord's agreement to do any of the foregoing without being deemed to have accepted possession of the Premises. The provisions of this **Section 2.2** are intended to constitute "an express provision to the contrary" within the meaning of Section 223-a of the New York Real Property Law or any successor Requirement.

Section 2.3 Payment of Rent. Tenant shall pay to Landlord, without notice or demand, and without any set-off, counterclaim, abatement or deduction whatsoever, except as may be expressly set forth in this Lease, in lawful money of the United States by wire transfer of funds, (i) Fixed Rent in equal monthly installments, in advance, on the first day of each month during the Term, commencing on the Rent Commencement Date, and (ii) Additional Rent, at the times and in the manner set forth in this Lease.

Section 2.4 First Month's Rent. Tenant shall pay one month's Fixed Rent upon the execution of this Lease ("**Advance Rent**"). If the Rent Commencement Date is on the first day of a month, the Advance Rent shall be credited towards the first month's Fixed Rent payment. If the Rent Commencement Date is not the first day of a month, then on the Rent Commencement Date Tenant shall pay Fixed Rent for the period from the Rent Commencement Date through the last day of such month, and the Advance Rent shall be credited towards Fixed Rent for the next succeeding calendar month.

ARTICLE 3

USE AND OCCUPANCY

Tenant shall use and occupy the Premises for the Permitted Uses and for no other purpose. Tenant shall not use or occupy or permit the use or occupancy of any part of the Premises in a manner constituting a Prohibited Use. If Tenant uses the Premises for a purpose constituting a Prohibited Use, violating any Requirement, or causing the Building to be in violation of any Requirement, then Tenant shall promptly discontinue such use upon notice of such violation. Tenant, at its expense, shall procure and at all times maintain and comply with the terms and conditions of all licenses and permits required for the lawful conduct of the Permitted Uses in the Premises. Landlord shall during the Term keep in effect at all times a certificate of occupancy issued for the Building permitting the use of the Premises as offices.

ARTICLE 4

CONDITION OF THE PREMISES

Tenant has inspected the Premises and agrees (a) to accept possession of the Premises in the condition existing on the Commencement Date "as is", and (b) except for Landlord's Work described in **Exhibit C** attached hereto, Landlord has no obligation to perform any work, supply any materials, incur any expense or make any alterations or improvements to prepare the Premises for Tenant's occupancy. Any work to be performed by Tenant in connection with Tenant's initial occupancy of the Premises shall be hereinafter referred to as the "**Initial Installations**". Tenant's occupancy of any part of the Premises shall be conclusive evidence, as against Tenant, that Landlord has Substantially Completed any work to be performed by Landlord under this Lease, Tenant has accepted possession of the Premises in its then current condition and at the time such possession was taken, the Premises and the Building were in a good and satisfactory condition as required by this Lease.

ARTICLE 5

ALTERATIONS

Section 5.1 Tenant's Alterations. (a) Tenant shall not make any alterations, additions or other physical changes in or about the Premises (collectively, "**Alterations**") other than decorative Alterations such as painting, wall coverings and floor coverings (collectively, "**Decorative Alterations**"), without Landlord's prior consent, which consent shall not be unreasonably withheld if such Alterations (i) are non-structural and do not affect any Building Systems, (ii) affect only the Premises and are not visible from outside of the Premises, (iii) do not affect the certificate of occupancy issued for the Building or the Premises, and (iv) do not violate any Requirement ("**Non-Structural Alterations**").

(b) **Plans and Specifications.** Prior to making any Alterations, Tenant, at its expense, shall (i) submit to Landlord for its approval, detailed plans and specifications ("**Plans**") of each proposed Alteration (other than Decorative Alterations), and with respect to any Alteration affecting any Building System, evidence that the Alteration has been designed by, or reviewed and approved by, Landlord's designated engineer for the affected Building System,

(ii) obtain all permits, approvals and certificates required by any Governmental Authorities, (iii) furnish to Landlord duplicate original policies or certificates of worker's compensation (covering all persons to be employed by Tenant, and Tenant's contractors and subcontractors in connection with such Alteration) and commercial general liability (including property damage coverage) insurance and Builder's Risk coverage (as described in **Article 11**) all in such form, with such companies, for such periods and in such amounts as Landlord may reasonably require, naming Landlord, Landlord's Agent, any Lessor and any Mortgagee as additional insureds, and (iv) furnish to Landlord reasonably satisfactory evidence of Tenant's ability to complete and to fully pay for such Alterations (other than Decorative Alterations). Tenant shall give Landlord not less than 5 Business Days' notice prior to performing any Decorative Alteration, which notice shall contain a description of such Decorative Alteration.

(c) **Governmental Approvals.** Tenant, at its expense, shall, as and when required, promptly obtain certificates of partial and final approval of such Alterations required by any Governmental Authority and shall, within 30 days after completion of any Alterations, furnish Landlord with copies thereof, together with "as-built" Plans for such Alterations prepared on an AutoCAD Computer Assisted Drafting and Design System (or such other system or medium as Landlord may accept), using naming conventions issued by the American Institute of Architects in June, 1990 (or such other naming conventions as Landlord may accept) and magnetic computer media of such record drawings and specifications translated in DXF format or another format acceptable to Landlord.

Section 5.2 Manner and Quality of Alterations. All Alterations shall be performed (a) in a good and workmanlike manner and free from defects, (b) substantially in accordance with the Plans, and by contractors approved by Landlord, and (c) in compliance with all Requirements, the terms of this Lease and all construction procedures and regulations then prescribed by Landlord. All materials and equipment shall be of first quality and at least equal to the applicable standards for the Building then established by Landlord, and no such materials or equipment (other than Tenant's Property) shall be subject to any lien or other encumbrance.

Section 5.3 Removal of Tenant's Property. Tenant's Property shall remain the property of Tenant and Tenant may remove the same at any time on or before the Expiration Date. On or prior to the Expiration Date, Tenant shall, at Tenant's Expense, remove all of Tenant's Property and, unless otherwise directed by Landlord, any Specialty Alterations from the Premises and close up any slab penetrations in the Premises. Tenant shall repair and restore, in a good and workmanlike manner, any damage to the Premises or the Building caused by Tenant's removal of any Specialty Alterations or Tenant's Property or by the closing of any slab penetrations, and upon default thereof, Tenant shall reimburse Landlord for Landlord's cost of repairing and restoring such damage. Any Specialty Alterations or Tenant's Property not so removed shall be deemed abandoned and Landlord may retain or remove and dispose of same, and repair and restore any damage caused thereby, at Tenant's cost and without accountability to Tenant. All other Alterations shall become Landlord's property upon termination of this Lease.

Section 5.4 Mechanic's Liens. Tenant, at its expense, shall discharge any lien or charge recorded or filed against the Real Property in connection with any work done or claimed to have been done by or on behalf of, or materials furnished or claimed to have been furnished to, Tenant, within 30 days after Tenant's receipt of notice thereof by payment, filing the bond required by law or otherwise in accordance with law.

Section 5.5 Labor Relations. Tenant shall not employ, or permit the employment of, any contractor, mechanic or laborer, or permit any materials to be delivered to or used in the Building, if, in Landlord's sole judgment, such employment, delivery or use will interfere or cause any conflict with other contractors, mechanics or laborers engaged in the construction, maintenance or operation of the Building by Landlord, Tenant or others. If such interference or conflict occurs, upon Landlord's request, Tenant shall cause all contractors, mechanics or laborers causing such interference or conflict to leave the Building immediately.

Section 5.6 Tenant's Costs. Tenant shall pay promptly to Landlord, upon demand, all reasonable out-of-pocket costs actually incurred by Landlord in connection with Tenant's Alterations, including costs incurred in connection with (a) Landlord's review of the Alterations (including review of requests for approval thereof) and (b) the provision of Building personnel during the performance of any Alteration, to operate elevators or otherwise to facilitate Tenant's Alterations. In addition, if Tenant's Alterations (other than the Initial Installations and Decorative Alterations) cost more than \$75,000, Tenant shall pay to Landlord, upon demand, an administrative fee in an amount equal to 5% of the total cost of such Alterations. Tenant shall, upon request, provide Landlord with reasonable evidence of all amounts expended by it for Alterations (including "soft costs").

Section 5.7 Tenant's Equipment. Tenant shall provide notice to Landlord prior to moving any heavy machinery, heavy equipment, freight, bulky matter or fixtures (collectively, "Equipment") into or out of the Building and shall pay to Landlord any costs actually incurred by Landlord in connection therewith. If such Equipment requires special handling, Tenant agrees (a) to employ only persons holding all necessary licenses to perform such work, (b) all work performed in connection therewith shall comply with all applicable Requirements and (c) such work shall be done only during hours designated by Landlord.

Section 5.8 Legal Compliance. The approval of Plans, or consent by Landlord to the making of any Alterations, does not constitute Landlord's representation that such Plans or Alterations comply with any Requirements. Landlord shall not be liable to Tenant or any other party in connection with Landlord's approval of any Plans, or Landlord's consent to Tenant's performing any Alterations. If any Alterations made by or on behalf of Tenant, require Landlord to make any alterations or improvements to any part of the Building in order to comply with any Requirements, Tenant shall pay all costs and expenses incurred by Landlord in connection with such alterations or improvements.

Section 5.9 Floor Load. Tenant shall not place a load upon any floor of the Premises that exceeds 50 pounds per square foot "live load". Landlord reserves the right to reasonably designate the position of all Equipment which Tenant wishes to place within the Premises, and to place limitations on the weight thereof.

ARTICLE 6

REPAIRS

Section 6.1 Landlord's Repair and Maintenance. Landlord shall operate, maintain and, except as provided in **Section 6.2** hereof, make all necessary repairs (both structural and nonstructural) to (i) the Building Systems, (ii) the Common Areas, and (iii) the structural components of the Building (including those located in the Premises except as otherwise

provided in **Article 8** hereof), in conformance with standards applicable to Comparable Buildings.

Section 6.2 Tenant's Repair and Maintenance. Tenant shall promptly, at its expense and in compliance with **Article 5**, make all nonstructural repairs to the Premises and the fixtures, equipment and appurtenances therein (including all electrical, plumbing, heating, ventilation and air conditioning, sprinklers and life safety systems in and serving the Premises from the point of connection to the Building Systems) (collectively, "**Tenant Fixtures**") as and when needed to preserve the Premises in good working order and condition, except for reasonable wear and tear and damage for which Tenant is not responsible. All damage to the Building or to any portion thereof, or to any Tenant Fixtures requiring structural or nonstructural repair caused by or resulting from any act, omission, neglect or improper conduct of a Tenant Party or the moving of Tenant's Property or Equipment into, within or out of the Premises by a Tenant Party, shall be repaired at Tenant's expense by (i) Tenant, if the required repairs are nonstructural in nature and do not affect any Building System, or (ii) Landlord, if the required repairs are structural in nature, involve replacement of exterior window glass or affect any Building System. All Tenant repairs shall be of good quality utilizing new construction materials.

Section 6.3 Restorative Work. Landlord reserves the right to make all changes, alterations, additions, improvements, repairs or replacements to the Building and Building Systems, including changing the arrangement or location of entrances or passageways, doors and doorways, corridors, elevators, stairs, toilets or other Common Areas (collectively, "**Restorative Work**"), as Landlord deems necessary or desirable, and to take all materials into the Premises required for the performance of such Restorative Work provided that (a) the level of any Building service shall not decrease in any material respect from the level required of Landlord in this Lease as a result thereof (other than temporary changes in the level of such services during the performance of any such Restorative Work) and (b) Tenant is not deprived of access to the Premises. Landlord shall use reasonable efforts to minimize interference with Tenant's use and occupancy of the Premises during the performance of such Restorative Work. There shall be no Rent abatement or allowance to Tenant for a diminution of rental value, no actual or constructive eviction of Tenant, in whole or in part, no relief from any of Tenant's other obligations under this Lease, and no liability on the part of Landlord by reason of inconvenience, annoyance or injury to business arising from Landlord, Tenant or others performing, or failing to perform, any Restorative Work. Subject to **Section 11.2**, Landlord agrees to indemnify Tenant against any loss to its Personal Property located within the Premises resulting from any Restorative Work performed by Landlord within the Premises.

ARTICLE 7

INCREASES IN TAXES AND OPERATING EXPENSES

Section 7.1 Definitions. For the purposes of this **Article 7**, the following terms shall have the meanings set forth below:

(a) "**Assessed Valuation**" shall mean the amount for which the Real Property is assessed pursuant to the applicable provisions of the City Charter and the Administrative Code of New York, or any successor Requirements, for the purpose of imposition of Taxes.

(b) **"Base Operating Expenses"** shall mean the Operating Expenses for the Base Expense Year.

(c) **"Base Taxes"** shall mean one-half of the aggregate Taxes payable for the Base Tax Years.

(d) **"Comparison Year"** shall mean (i) with respect to Taxes, each calendar year commencing subsequent to the first day of the Base Tax Year commencing on July 1, 2003 and ending on June 30, 2004, and (ii) with respect to Operating Expenses, each calendar year commencing subsequent to the first day of the Base Expense Year.

(e) **"Operating Expenses"** shall mean the aggregate of all costs and expenses paid or incurred by or on behalf of Landlord in connection with the ownership, operation, repair and maintenance of the Real Property, including the rental value of Landlord's Building office and capital improvements incurred after the Base Expense Year only if such capital improvement either (i) is reasonably intended to result in a reduction in Operating Expenses (as for example, a labor-saving improvement) provided, the amount included in Operating Expenses in any Comparison Year shall not exceed an amount equal to the savings reasonably anticipated to result from the installation and operation of such improvement, and/or (ii) is made during any Comparison Year in compliance with Requirements. Such capital improvements shall be amortized (with interest at the Base Rate) on a straight-line basis over the useful life thereof as Landlord shall reasonably determine, and the amount included in Operating Expenses in any Comparison Year shall be equal to the annual amortized amount. Operating Expenses shall not include any Excluded Expenses. If during all or part of the Base Expense Year or any Comparison Year, Landlord shall not furnish any particular item(s) of work or service (which would otherwise constitute an Operating Expense) to any leasable portions of the Building for any reason, then, for purposes of computing Operating Expenses for such period, the amount included in Operating Expenses for such period shall be increased by an amount equal to the costs and expenses that would have been reasonably incurred by Landlord during such period if Landlord had furnished such item(s) of work or service to such portion of the Building. In determining the amount of Operating Expenses for the Base Expense Year or any Comparison Year, if less than 95% of the Building rentable area is occupied by tenants at any time during the Base Expense Year or any such Comparison Year, Operating Expenses shall be determined for the Base Expense Year or such Comparison Year to be an amount equal to the like expenses which would normally be expected to be incurred had such occupancy been 95% throughout the Base Expense Year or such Comparison Year.

(f) **"Statement"** shall mean a statement containing a comparison of (i) the Base Taxes and the Taxes for any Comparison Year, or (ii) the Base Operating Expenses and the Operating Expenses for any Comparison Year.

(g) **"Tax Year"** shall mean the twelve month period from July 1 through June 30 (or such other period as hereinafter may be duly adopted by the City of New York as its fiscal year for real estate tax purpose).

(h) **"Taxes"** shall mean (i) all real estate taxes, assessments (including assessments made as a result of the Building being within a business improvement district), and other governmental levies, impositions or charges, whether general, special, ordinary, extraordinary, foreseen or unforeseen, which may be assessed, levied or imposed upon all or any part of the Real Property, and (ii) all expenses (including reasonable attorneys' fees and disbursements and experts' and other witnesses' fees) incurred in contesting any of the

foregoing or the Assessed Valuation of the Real Property (but such expenses shall not be included in Base Taxes if incurred during the Base Tax Year). Taxes shall not include (x) interest or penalties incurred by Landlord as a result of Landlord's late payment of Taxes, or (y) franchise, transfer, gift, inheritance, estate or net income taxes imposed upon Landlord. If Landlord elects to pay any assessment in annual installments, then (i) such assessment shall be deemed to have been so divided and to be payable in the maximum number of installments permitted by law, and (ii) there shall be deemed included in Taxes for each Comparison Year the installments of such assessment becoming payable during such Comparison Year, together with interest payable during such Comparison Year on such installments and on all installments thereafter becoming due as provided by law, all as if such assessment had been so divided. If at any time the methods of taxation prevailing on the Commencement Date shall be altered so that in lieu of or as an addition to the whole or any part of Taxes, there shall be assessed, levied or imposed (1) a tax, assessment, levy, imposition or charge based on the income or rents received from the Real Property whether or not wholly or partially as a capital levy or otherwise, (2) a tax, assessment, levy, imposition or charge measured by or based in whole or in part upon all or any part of the Real Property and imposed upon Landlord, (3) a license fee measured by the rents, or (4) any other tax, assessment, levy, imposition, charge or license fee however described or imposed, then all such taxes, assessments, levies, impositions, charges or license fees or the part thereof so measured or based shall be deemed to be Taxes.

Section 7.2 Tenant's Tax Payment. (a) If the Taxes payable for any Tax Year after the Base Tax Year commencing on July 1, 2003 and ending on June 30, 2004 exceed the Base Taxes, Tenant shall pay to Landlord Tenant's Proportionate Share of such excess ("**Tenant's Tax Payment**"). For each Comparison Year in which any such Tax Year commences, Landlord shall furnish to Tenant a statement setting forth Landlord's reasonable estimate of Tenant's Tax Payment for such Tax Year (the "**Tax Estimate**"). Tenant shall pay to Landlord on the 1st day of each month during such Comparison Year an amount equal to 1/12th of the Tax Estimate for such Tax Year. If Landlord furnishes a Tax Estimate for a Comparison Year subsequent to the commencement thereof, then (i) until the 1st day of the month following the month in which the Tax Estimate is furnished to Tenant, Tenant shall pay to Landlord on the 1st day of each month an amount equal to the monthly sum payable by Tenant to Landlord under this **Section 7.2(a)** for the last month of the preceding Comparison Year; (ii) promptly after the Tax Estimate is furnished to Tenant or together therewith, Landlord shall give notice to Tenant stating whether the installments of the Tax Estimate previously made for such Comparison Year were greater or less than the installments of the Tax Estimate to be made for such Comparison Year in accordance with the Tax Estimate, and (x) if there shall be a deficiency, Tenant shall pay the amount thereof within 10 Business Days after demand, or (y) if there shall have been an overpayment, Landlord shall credit the amount thereof against subsequent payments of Rent next coming due hereunder, provided if such overpayment exceeds the remaining amount of Rent due hereunder for the remainder of the Term, Landlord shall, provided no Event of Default has occurred and is then continuing, pay to Tenant the amount by which such overpayment exceeds the remaining Rent; and (iii) on the 1st day of the month following the month in which the Tax Estimate is furnished to Tenant, and on the 1st day of each month thereafter throughout the remainder of such Comparison Year, Tenant shall pay to Landlord an amount equal to 1/12th of the Tax Estimate. Landlord may, during each Comparison Year, furnish to Tenant a revised Tax Estimate for such Comparison Year, and in such case, Tenant's Tax Payment for such Comparison Year shall be adjusted and any deficiencies paid or overpayments credited, as the case may be, substantially in the same manner as provided in the preceding sentence. After the end of each Comparison Year, Landlord shall furnish to Tenant a Statement of Taxes applicable to Tenant's Tax Payment payable for such Comparison Year and (A) if such Statement shall show that the sums so paid by Tenant were less than Tenant's Tax Payment

due for such Comparison Year, Tenant shall pay to Landlord the amount of such deficiency within 10 Business Days after delivery of the Statement to Tenant, or (B) if such Statement shall show that the sums so paid by Tenant were more than such Tenant's Tax Payment, Landlord shall credit such overpayment against subsequent payments of Rent next coming due hereunder, provided if such overpayment exceeds the remaining amount of Rent due hereunder for the remainder of the Term, Landlord shall, provided no Event of Default has occurred and is then continuing, pay to Tenant the amount by which such overpayment exceeds the remaining Rent, if any. If there shall be any increase in the Taxes for any Tax Year, whether during or after such Tax Year, or if there shall be any decrease in the Taxes for any Tax Year, Tenant's Tax Payment for such Comparison Year shall be appropriately adjusted and any deficiencies paid or overpayments credited, as the case may be, substantially in the same manner as provided in the preceding sentence.

(b) Only Landlord may institute proceedings to reduce the Assessed Valuation of the Real Property and the filings of any such proceeding by Tenant without Landlord's consent shall constitute an Event of Default. If the Base Taxes are reduced, the Additional Rent previously paid or payable on account of Tenant's Tax Payment hereunder for all Comparison Years shall be recomputed on the basis of such reduction, and Tenant shall pay to Landlord, within 10 Business Days after demand therefor, any deficiency between the amount of such Additional Rent previously computed and paid by Tenant to Landlord, and the amount due as a result of such recomputation. If the Base Taxes are increased, then Landlord shall credit against subsequent payments of Rent due the amount by which such Additional Rent previously paid on account of Tenant's Tax Payment exceeds the amount actually due as a result of such recomputation, provided if such overpayment exceeds the remaining amount of Rent due hereunder for the remainder of the Term, Landlord shall, provided no Event of Default has occurred and is then continuing, pay to Tenant the amount by which such overpayment exceeds the remaining Rent, if any. If Landlord receives a refund of Taxes for any Comparison Year, Landlord shall reasonably promptly, at its election, either pay to Tenant, or credit against subsequent payments of Rent due hereunder, an amount equal to Tenant's Proportionate Share of the refund, net of any expenses incurred by Landlord in achieving such refund, which amount shall not exceed Tenant's Tax Payment paid for such Comparison Year. Landlord shall not be obligated to file any application or institute any proceeding seeking a reduction in Taxes or the Assessed Valuation. The benefit of any exemption or abatement relating to all or any part of the Real Property shall accrue solely to the benefit of Landlord and Taxes shall be computed without taking into account any such exemption or abatement.

(c) Tenant shall be responsible for any applicable occupancy or rent tax now in effect or hereafter enacted and, if such tax is payable by Landlord, Tenant shall promptly pay such amounts to Landlord, upon Landlord's demand.

(d) Tenant shall be obligated to make Tenant's Tax Payment regardless of whether Tenant may be exempt from the payment of any taxes as the result of any reduction, abatement, or exemption from Taxes granted or agreed to by any Governmental Authority, or by reason of Tenant's diplomatic or other tax exempt status.

(e) Upon Tenant's request, Landlord shall reasonably promptly provide Tenant with a copy of the tax bill for the Real Property for the then current Tax Year, if Landlord has such tax bill.

Section 7.3 Tenant's Operating Payment. (a) If the Operating Expenses payable for any Comparison Year exceed the Base Operating Expenses, Tenant shall pay to Landlord

Tenant's Proportionate Share of such excess ("**Tenant's Operating Payment**"). For each Comparison Year, Landlord shall furnish to Tenant a statement setting forth Landlord's reasonable estimate of Tenant's Operating Payment for such Comparison Year (the "**Expense Estimate**"). Tenant shall pay to Landlord on the 1st day of each month during such Comparison Year an amount equal to 1/12 of the Expense Estimate. If Landlord furnishes an Expense Estimate for a Comparison Year subsequent to the commencement thereof, then (i) until the 1st day of the month following the month in which the Expense Estimate is furnished to Tenant, Tenant shall pay to Landlord on the 1st day of each month an amount equal to the monthly sum payable by Tenant to Landlord under this **Section 7.3** during the last month of the preceding Comparison Year, (ii) promptly after the Expense Estimate is furnished to Tenant or together therewith, Landlord shall give notice to Tenant stating whether the installments of Tenant's Operating Payment previously made for such Comparison Year were greater or less than the installments of Tenant's Operating Payment to be made for such Comparison Year in accordance with the Expense Estimate, and (A) if there shall be a deficiency, Tenant shall pay the amount thereof within 10 Business Days after demand therefor, or (B) if there shall have been an overpayment, Landlord shall credit the amount thereof against subsequent payments of Rent due hereunder, provided if such overpayment exceeds the remaining amount of Rent due hereunder for the remainder of the Term, Landlord shall, provided no Event of Default has occurred and is then continuing, pay to Tenant the amount by which such overpayment exceeds the remaining Rent, if any, and (iii) on the 1st day of the month following the month in which the Expense Estimate is furnished to Tenant, and on the 1st day of each month thereafter throughout the remainder of such Comparison Year, Tenant shall pay to Landlord an amount equal to 1/12 of the Expense Estimate.

(b) On or before May 1st of each Comparison Year, Landlord shall furnish to Tenant a Statement for the immediately preceding Comparison Year. If the Statement shows that the sums paid by Tenant under **Section 7.3(a)** exceeded the actual amount of Tenant's Operating Payment for such Comparison Year, Landlord shall credit the amount of such excess against subsequent payments of Rent due hereunder, provided if such overpayment exceeds the remaining amount of Rent due hereunder for the remainder of the Term, Landlord shall, provided no Event of Default has occurred and is then continuing, pay to Tenant the amount by which such overpayment exceeds the remaining Rent, if any. If the Statement shows that the sums so paid by Tenant were less than Tenant's Operating Payment for such Comparison Year, Tenant shall pay the amount of such deficiency within 10 Business Days after delivery of the Statement to Tenant.

Section 7.4 Non-Waiver; Disputes. (a) Landlord's failure to render any Statement on a timely basis with respect to any Comparison Year shall not prejudice Landlord's right to thereafter render a Statement with respect to such Comparison Year or any subsequent Comparison Year, nor shall the rendering of a Statement prejudice Landlord's right to thereafter render a corrected Statement for that Comparison Year.

(b) Each Statement sent to Tenant shall be conclusively binding upon Tenant unless Tenant (i) pays to Landlord when due the amount set forth in such Statement, without prejudice to Tenant's right to dispute such Statement, and (ii) within 60 days after such Statement is sent, sends a notice to Landlord objecting to such Statement and specifying the reasons therefor. Tenant agrees that Tenant will not employ, in connection with any dispute under this Lease, any person or entity who is to be compensated in whole or in part, on a contingency fee basis. If the parties are unable to resolve any dispute as to the correctness of such Statement within 30 days following such notice of objection, either party may refer the issues raised to a nationally recognized independent public accounting firm selected by

Landlord and reasonably acceptable to Tenant, and the decision of such accountants shall be conclusively binding upon Landlord and Tenant. In connection therewith, Tenant and such accountants shall execute and deliver to Landlord a confidentiality agreement, in form and substance reasonably satisfactory to Landlord, whereby such parties agree not to disclose to any third party any of the information obtained in connection with such review. Tenant shall pay the fees and expenses relating to such procedure, unless such accountants determine that Landlord overstated Operating Expenses by more than 5% for such Comparison Year, in which case Landlord shall pay such fees and expenses. Except as provided in this Section, Tenant shall have no right whatsoever to dispute by judicial proceeding or otherwise the accuracy of any Statement.

Section 7.5 Proration. If the Rent Commencement Date is not January 1, the Additional Rent for the applicable Comparison Year shall be apportioned on the basis of the number of days in the year from the Rent Commencement Date to the following December 31. If the Expiration Date occurs on a date other than December 31, any Additional Rent under this **Article 7** for the Comparison Year in which such Expiration Date occurs shall be apportioned on the basis of the number of days in the year from January 1 to the Expiration Date. Upon the expiration or earlier termination of this Lease, any Additional Rent under this **Article 7** shall be adjusted or paid within 30 days after submission of the Statement for the last Comparison Year.

Section 7.6 No Reduction in Rent. In no event shall any decrease in Operating Expenses or Taxes in any Comparison Year below the Base Operating Expenses or Base Taxes, as the case may be, result in a reduction in the Fixed Rent or any other component of Additional Rent payable hereunder.

ARTICLE 8

REQUIREMENTS OF LAW

Section 8.1 Compliance with Requirements.

(a) **Tenant's Compliance.** Tenant, at its expense, shall comply with all Requirements applicable to the Premises; provided, however, that Tenant shall not be obligated to comply with any Requirements requiring any structural alterations to the Building unless the application of such Requirements arises from (i) the specific manner and nature of Tenant's use or occupancy of the Premises, as distinct from general office use, (ii) Alterations made by Tenant, or (iii) a breach by Tenant of any provisions of this Lease. Any such repairs or alterations shall be made at Tenant's expense (1) by Tenant in compliance with **Article 5** if such repairs or alterations are nonstructural and do not affect any Building System, or (2) by Landlord if such repairs or alterations are structural or affect any Building System. If Tenant obtains knowledge of any failure to comply with any Requirements applicable to the Premises, Tenant shall give Landlord prompt notice thereof.

(b) **Hazardous Materials.** Tenant shall not cause or permit (i) any Hazardous Materials to be brought into the Building, (ii) the storage or use of Hazardous Materials in any manner other than in full compliance with any Requirements, or (iii) the escape, disposal or release of any Hazardous Materials within or in the vicinity of the Building. Nothing herein shall be deemed to prevent Tenant's use of any Hazardous Materials customarily used in the ordinary course of office work, provided such use is in accordance with all Requirements. Tenant shall be responsible, at its expense, for all matters directly or indirectly based on, or

arising or resulting from the presence of Hazardous Materials in the Building which is caused or permitted by a Tenant Party. Tenant shall provide to Landlord copies of all communications received by Tenant with respect to any Requirements relating to Hazardous Materials, and/or any claims made in connection therewith. Landlord or its agents may perform environmental inspections of the Premises at any time.

(c) **Landlord's Compliance.** Landlord shall comply with (or cause to be complied with) all Requirements applicable to the Building which are not the obligation of Tenant, to the extent that non-compliance would materially impair Tenant's use and occupancy of the Premises for the Permitted Uses.

(d) **Landlord's Insurance.** Tenant shall not cause or permit any action or condition that would (i) invalidate or conflict with Landlord's insurance policies, (ii) violate applicable rules, regulations and guidelines of the Fire Department, Fire Insurance Rating Organization or any other authority having jurisdiction over the Building, (iii) cause an increase in the premiums of fire insurance for the Building over that payable with respect to Comparable Buildings, or (iv) result in Landlord's insurance companies' refusing to insure the Building or any property therein in amounts and against risks as reasonably determined by Landlord. If fire insurance premiums increase as a result of Tenant's failure to comply with the provisions of this **Section 8.1**, Tenant shall promptly cure such failure and shall reimburse Landlord for the increased fire insurance premiums paid by Landlord as a result of such failure by Tenant.

Section 8.2 Fire and Life Safety; Sprinkler. Tenant shall maintain in good order and repair the sprinkler, fire-alarm and life-safety system in the Premises in accordance with this Lease, the Rules and Regulations and all Requirements. If the Fire Insurance Rating Organization or any Governmental Authority or any of Landlord's insurers requires or recommends any modifications and/or alterations be made or any additional equipment be supplied in connection with the sprinkler system or fire alarm and life-safety system serving the Building by reason of Tenant's business, any Alterations performed by Tenant or the location of the partitions, Tenant's Property, or other contents of the Premises, Landlord (to the extent outside of the Premises) or Tenant (to the extent within the Premises) shall make such modifications and/or Alterations, and supply such additional equipment, in either case at Tenant's expense.

ARTICLE 9

SUBORDINATION

Section 9.1 Subordination and Attornment. (a) This Lease is subject and subordinate to all Mortgages and Superior Leases, and, at the request of any Mortgagee or Lessor, Tenant shall attorn to such Mortgagee or Lessor, its successors in interest or any purchaser in a foreclosure sale.

(b) If a Lessor or Mortgagee or any other person or entity shall succeed to the rights of Landlord under this Lease, whether through possession or foreclosure action or the delivery of a new lease or deed, then at the request of the successor landlord and upon such successor landlord's written agreement to accept Tenant's attornment and to recognize Tenant's interest under this Lease, Tenant shall be deemed to have attorned to and recognized such successor landlord as Landlord under this Lease. The provisions of this **Section 9.1** are self-operative and require no further instruments to give effect hereto; provided, however, that

Tenant shall promptly execute and deliver any instrument that such successor landlord may reasonably request (i) evidencing such attornment, (ii) setting forth the terms and conditions of Tenant's tenancy, and (iii) containing such other terms and conditions as may be required by such Mortgagee or Lessor, provided such terms and conditions do not increase the Rent, materially increase Tenant's other obligations or materially and adversely affect Tenant's rights under this Lease. Upon such attornment this Lease shall continue in full force and effect as a direct lease between such successor landlord and Tenant upon all of the terms, conditions and covenants set forth in this Lease except that such successor landlord shall not be

(A) liable for any act or omission of Landlord (except to the extent such act or omission continues beyond the date when such successor landlord succeeds to Landlord's interest and Tenant gives notice of such act or omission);

(B) subject to any defense, claim, counterclaim, set-off or offset which Tenant may have against Landlord;

(C) bound by any prepayment of more than one month's Rent to any prior landlord;

(D) bound by any obligation to make any payment to Tenant which was required to be made prior to the time such successor landlord succeeded to Landlord's interest;

(E) bound by any obligation to perform any work or to make improvements to the Premises except for (x) repairs and maintenance required to be made by Landlord under this Lease, and (y) repairs to the Premises as a result of damage by fire or other casualty or a partial condemnation pursuant to the provisions of this Lease, but only to the extent that such repairs can reasonably be made from the net proceeds of any insurance or condemnation awards, respectively, actually made available to such successor landlord;

(F) bound by any modification, amendment or renewal of this Lease made without successor landlord's consent;

(G) liable for the repayment of any security deposit or surrender of any letter of credit, unless and until such security deposit actually is paid or such letter of credit is actually delivered to such successor landlord; or

(H) liable for the payment of any unfunded tenant improvement allowance, refurbishment allowance or similar obligation.

(c) Tenant shall from time to time within 10 days of request from Landlord execute and deliver any documents or instruments that may be reasonably required by any Mortgagee or Lessor to confirm any subordination.

Section 9.2 Mortgage or Superior Lease Defaults. Any Mortgagee may elect that this Lease shall have priority over the Mortgage and, upon notification to Tenant by such Mortgagee, this Lease shall be deemed to have priority over such Mortgage, regardless of the date of this Lease. In connection with any financing of the Real Property, Tenant shall consent to any reasonable modifications of this Lease requested by any lending institution, provided

such modifications do not increase the Rent, or, other than to a de minimis extent, increase the other obligations or adversely affect the rights of Tenant under this Lease.

Section 9.3 Tenant's Termination Right. As long as any Superior Lease or Mortgage exists, Tenant shall not seek to terminate this Lease by reason of any act or omission of Landlord until (a) Tenant shall have given notice of such act or omission to all Lessors and/or Mortgagees whose names and addresses have been provided to Tenant, and (b) a reasonable period of time shall have elapsed following the giving of notice of such default and the expiration of any applicable notice or grace periods (unless such act or omission is not capable of being remedied within a reasonable period of time), during which period such Lessors and/or Mortgagees shall have the right, but not the obligation, to remedy such act or omission and thereafter diligently proceed to so remedy such act or obligation. If any Lessor or Mortgagee elects to remedy such act or omission of Landlord, Tenant shall not seek to terminate this Lease so long as such Lessor or Mortgagee is proceeding with reasonable diligence to effect such remedy.

Section 9.4 Provisions. The provisions of this **Article 9** shall (a) inure to the benefit of Landlord, any future owner of the Building or the Real Property, Lessor or Mortgagee and any sublessor thereof and (b) apply notwithstanding that, as a matter of law, this Lease may terminate upon the termination of any such Superior Lease or Mortgage.

Section 9.5 Future Condominium Declaration. This Lease and Tenant's rights hereunder are and will be subject and subordinate to any condominium declaration, by-laws and other instruments (collectively, the "**Declaration**") which may be recorded in order to subject the Building to a condominium form of ownership pursuant to Article 9-B of the New York Real Property Law or any successor Requirement, provided that the Declaration does not by its terms increase the Rent or, other than to a de minimis extent, increase Tenant's non-Rent obligations or adversely affect Tenant's rights under this Lease. At Landlord's request, and subject to the foregoing proviso, Tenant will execute and deliver to Landlord an amendment of this Lease confirming such subordination and modifying this Lease to conform to such condominium regime.

Section 9.6 Non-Disturbance Agreement. Landlord hereby agrees to use reasonable efforts to obtain for Tenant, at no cost to Landlord, a subordination, non-disturbance and attornment agreement from all existing Mortgagees, in the standard form customarily employed by such Mortgagees, provided that Landlord shall have no liability to Tenant, and the subordination of this Lease to any Mortgage shall not be affected, in the event that it is unable to obtain any such agreements. Tenant shall reimburse Landlord, within 30 days after demand therefor, for Landlord's out-of-pocket costs, including reasonable attorney's fees and disbursements, incurred in connection with such efforts.

ARTICLE 10

SERVICES

Section 10.1 Electricity. (a) Landlord shall redistribute or furnish electricity to or for the use of Tenant in the Premises for the operation of Tenant's electrical systems and equipment in the Premises, at a level sufficient to accommodate a demand load of six (6) watts per usable square foot of office space in the Premises. An estimated charge for such electricity

(the "**Electrical Inclusion Factor**") is included in Fixed Rent on a so-called "rent inclusion" basis; however, the value to Tenant of such service may not be fully reflected in Fixed Rent. Accordingly, Tenant agrees that following the commencement of Tenant's ordinary business activities in the Premises, Landlord may cause an independent electrical engineer or electrical consulting firm selected by Landlord ("**Landlord's Consultant**") to make a determination, certified in writing to Landlord and Tenant, of the full value of the electrical service supplied to Tenant, based upon a survey indicating the lighting load, office equipment and all other electrical usage by Tenant. Thereafter, Landlord may, at any time and from time to time, at its sole option, cause Landlord's Consultant to make subsequent determinations of the then full value of the electrical service supplied to Tenant on the basis set forth in the immediately preceding sentence. If Landlord's Consultant reasonably determines that the full value of the electrical service supplied to Tenant exceeds the Electrical Inclusion Factor, as increased from time to time in accordance with this **Section 10.1**, then, upon notice to Tenant, Fixed Rent and the Electrical Inclusion Factor shall be increased to reflect the full value, on an annual basis, of such increased electrical usage by Tenant. Any increase in Fixed Rent and the Electrical Inclusion Factor shall be effective as of the date of the increase in Tenant's electrical usage, as determined by the survey, and Tenant's liability therefor shall be retroactive to such date. The computation of the Electrical Inclusion Factor under this **Article 10** is intended to constitute a formula for an agreed rental adjustment and may or may not constitute an actual reimbursement to Landlord for the electrical service supplied to Tenant pursuant to this Lease. If any tax is imposed on Landlord's receipts or income from the redistribution, furnishing, or sale of electricity to Tenant as provided for above (other than a general tax on corporate income not specific to the provision of electricity), whether based on the Electrical Inclusion Factor or any increase therein provided for above, or otherwise, Tenant shall reimburse Landlord for such tax, if and to the extent permitted by law. Notwithstanding any provision of this Lease to the contrary, Tenant shall pay to Landlord the Electrical Inclusion Factor (which is included in Fixed Rent) from and after the Commencement Date even if Fixed Rent (other than the Electrical Inclusion Factor) is not otherwise payable hereunder until the Rent Commencement Date, which payment shall be made at the same time and in the same manner as Fixed Rent (whether or not then payable). All electricity used during the performance of cleaning services, or the making of any Alterations or Restorative Work in the Premises, or the operation of any supplemental or special air-conditioning systems serving the Premises, shall be paid for by Tenant.

(b) **Electricity Rates.** If Landlord's cost of electricity increases or decreases after the Commencement Date for any reason whatsoever, then the Electrical Inclusion Factor shall be increased or decreased, as the case may be, in the same percentage for the remainder of the Term. Landlord's Consultant shall determine the percentage for the changes in the Electrical Inclusion Factor resulting from any change in Landlord's cost of electricity. Landlord shall notify Tenant of any such changes and any such increase or decrease in Fixed Rent and the Electrical Inclusion Factor shall be effective as of the date of such increase or decrease in Landlord's cost of electricity, and Tenant's liability therefor shall be retroactive to such date. Notwithstanding anything set forth herein to the contrary, the Electrical Inclusion Factor shall in no event be decreased below the amount set forth in **Article 1** of this Lease.

(c) **Submetering Option.** Landlord shall have the option at any time after the Commencement Date of installing submeters in the Premises at Landlord's expense to measure Tenant's electrical consumption. If Landlord exercises such option, Fixed Rent shall be reduced by an amount equal to the Electrical Inclusion Factor in effect as of commencement of the operation of such submeters, and Tenant shall pay to Landlord, from time to time, but no more frequently than monthly, for its consumption of electricity at the Premises, a sum equal to 105% of the product obtained by multiplying (i) the Cost Per Kilowatt Hour, and (ii) the actual number

of kilowatt hours of electric current consumed by Tenant in such billing period. If any tax is imposed upon Landlord's receipts from the sale or resale of electricity to Tenant, Tenant shall pay such tax if and to the extent permitted by law as if Tenant were the ultimate consumer of such electricity. Where more than one meter measures the electricity to Tenant, the electricity measured by each meter shall be computed and billed separately in accordance with the provisions set forth above. Bills for such amounts shall be rendered to Tenant at such times as Landlord may elect.

(d) **Compliance.** Tenant shall at all times comply with the rules and regulations of the utility company supplying electricity to the Building. Tenant shall not use any electrical equipment which, in Landlord's reasonable judgment, would exceed the capacity of the electrical equipment serving the Premises. If Landlord determines that Tenant's electrical requirements necessitate installation of any additional risers, feeders or other electrical distribution equipment (collectively, "**Electrical Equipment**"), or if Tenant provides Landlord with evidence reasonably satisfactory to Landlord of Tenant's need for excess electricity and requests that additional Electrical Equipment be installed, Landlord shall, at Tenant's expense, install such additional Electrical Equipment, provided that Landlord, in its reasonable judgment, determines that (i) such installation is practicable and necessary, (ii) such additional Electrical Equipment is permissible under applicable Requirements, and (iii) the installation of such Electrical Equipment will not cause permanent damage to the Building or the Premises, cause or create a hazardous condition, entail excessive or unreasonable alterations, interfere with or limit electrical usage by other tenants or occupants of the Building or exceed the limits of the switchgear or other facilities serving the Building, or require power in excess of that available from the utility serving the Building.

Section 10.2 Elevators. Landlord shall provide passenger elevator service to the Premises 24 hours per day, 7 days per week; provided, however, Landlord may limit passenger elevator service during times other than Ordinary Business Hours. Landlord shall provide at least one freight elevator serving the Premises available upon Tenant's prior request, on a non-exclusive "first come, first serve" basis with other Building tenants, on all Business Days from 8:00 a.m. to 11:45 a.m. and from 1:00 p.m. to 4:45 p.m., which hours of operation are subject to change.

Section 10.3 Heating, Ventilation and Air Conditioning. Landlord shall furnish to the Premises heating, ventilation and air-conditioning ("**HVAC**") in accordance with the Design Standards set forth in **Exhibit D** during Ordinary Business Hours. Landlord shall have access to all air-cooling, fan, ventilating and machine rooms and electrical closets and all other mechanical installations of Landlord (collectively, "**Mechanical Installations**"), and Tenant shall not construct partitions or other obstructions which may interfere with Landlord's access thereto or the moving of Landlord's equipment to and from the Mechanical Installations. No Tenant Party shall at any time enter the Mechanical Installations or tamper with, adjust, or otherwise affect such Mechanical Installations. Landlord shall not be responsible if the HVAC System fails to provide cooled or heated air, as the case may be, to the Premises in accordance with the Design Standards by reason of (i) any equipment installed by, for or on behalf of Tenant, which has an electrical load in excess of the average electrical load and human occupancy factors for the HVAC System as designed, or (ii) any rearrangement of partitioning or other Alterations made or performed by, for or on behalf of Tenant. Tenant shall install, if missing, blinds or shades on all windows, which blinds and shades shall be subject to Landlord's approval, and shall keep all of the operable windows in the Premises closed, and lower the blinds when necessary because of the sun's position, whenever the HVAC System is in operation or as and when required by any Requirement. Tenant shall cooperate with Landlord and shall abide by

the rules and regulations which Landlord may reasonably prescribe for the proper functioning and protection of the HVAC System.

Section 10.4 Overtime Freight Elevators and HVAC. The Fixed Rent does not include any charge to Tenant for the furnishing of any freight elevator service or HVAC to the Premises during any periods other than the hours set forth in **Sections 10.2 and 10.3 ("Overtime Periods")**. If Tenant desires any such services during Overtime Periods, Tenant shall deliver notice to the Building office requesting such services at least 24 hours prior to the time Tenant requests such services to be provided; provided, however, that Landlord shall use reasonable efforts to arrange such service on such shorter notice as Tenant shall provide. If Landlord furnishes freight elevator or HVAC service during Overtime Periods, Tenant shall pay to Landlord the cost thereof at the then established rates for such services in the Building.

Section 10.5 Cleaning. Landlord shall cause the Premises (excluding any portions thereof used for the storage, preparation, service or consumption of food or beverages, as an exhibition area or classroom, for storage, as a shipping room, mail room or similar purposes, for private bathrooms, showers or exercise facilities, as a trading floor, or primarily for operation of computer, data processing, reproduction, duplicating or similar equipment except that Landlord shall remove ordinary office refuse from such areas in accordance with **Section 10.7**) to be cleaned, substantially in accordance with the standards set forth in **Exhibit E**. Any areas of the Premises which Landlord is not required to clean hereunder or which require additional cleaning shall be cleaned, at Tenant's expense, by Landlord's cleaning contractor, at rates which shall be competitive with rates of other cleaning contractors providing comparable services to Comparable Buildings. Landlord's cleaning contractor and its employees shall have access to the Premises at all times except between 8:00 a.m. and 5:30 p.m. on weekdays which are not Observed Holidays.

Section 10.6 Water. Landlord shall provide cold water in the core lavatories on each floor of the Building. If Tenant requires water for any additional purposes, Tenant shall pay for the cost of bringing water to the Premises and Landlord may install a meter to measure the water. Tenant shall pay the cost of such installation, and for all maintenance, repairs and replacements thereto, and for the reasonable charges of Landlord for the water consumed.

Section 10.7 Refuse Removal. Landlord shall provide refuse removal services at the Building for ordinary office refuse and rubbish (provided such ordinary office refuse and rubbish in areas not cleaned by Landlord are adequately separated and identified). Tenant shall pay to Landlord Landlord's reasonable charge for such removal to the extent that the refuse generated by Tenant exceeds the refuse customarily generated by general office tenants. Tenant shall not dispose of any refuse in the Common Areas, and if Tenant does so, Tenant shall be liable for Landlord's reasonable charge for such removal.

Section 10.8 Directory. The lobby shall contain a computerized directory wherein the Building's tenants shall be listed with a capacity for up to 25 listings per floor for Tenant and others permitted to occupy the Premises hereunder. Tenant shall be entitled to a proportionate share of such listings based on the rentable square footage of the Premises. From time to time, but not more frequently than monthly, Landlord shall reprogram the computerized directory to reflect such changes in the listings therein as Tenant shall request. Tenant shall have no less than 20 listings in such directory.

Section 10.9 Telecommunications. If Tenant requests that Landlord grant access to the Building to a telecommunications service provider designated by Tenant for purposes of

providing telecommunications services to Tenant, Landlord shall use its good faith efforts to respond to such request within 30 days. Tenant acknowledges that nothing set forth in this **Section 10.9** shall impose any affirmative obligation on Landlord to grant such request and that Landlord, in its sole discretion, shall have the right to determine which telecommunications service providers shall have access to Building facilities.

Section 10.10 Service Interruptions. Landlord reserves the right to suspend any service when necessary, by reason of Unavoidable Delays, accidents or emergencies, or for Restorative Work which, in Landlord's reasonable judgment, are necessary or appropriate until such Unavoidable Delay, accident or emergency shall cease or such Restorative Work is completed and Landlord shall not be liable for any interruption, curtailment or failure to supply services. Landlord shall use reasonable efforts to minimize interference with Tenant's use and occupancy of the Premises as a result of any such interruption, curtailment or failure of or defect in such service, or change in the supply, character and/or quantity of electrical service, and to restore any such services, remedy such situation and minimize any interference with Tenant's business. Except as provided in **Section 10.11**, the exercise of any such right or the occurrence of any such failure by Landlord shall not constitute an actual or constructive eviction, in whole or in part, entitle Tenant to any compensation, abatement or diminution of Rent, relieve Tenant from any of its obligations under this Lease, or impose any liability upon Landlord or any Indemnified Party by reason of inconvenience to Tenant, or interruption of Tenant's business, or otherwise. Landlord shall not be liable in any way to Tenant for any failure, defect or interruption of, or change in the supply, character and/or quantity of electric service furnished to the Premises for any reason except if attributable to the gross negligence or willful misconduct of Landlord.

Section 10.11 Rent Abatement. Notwithstanding anything to the contrary contained in this Lease, if Tenant is unable to use the Premises for the ordinary conduct of Tenant's business due solely to (a) an interruption of an Essential Service (as hereinafter defined) resulting from Landlord's performance of an improvement to the Building or (b) Landlord's breach of an obligation under this Lease to perform repairs or replacements which results in Landlord's failure to provide an Essential Service, in each case other than as a result of Unavoidable Delays, casualty or condemnation, and such condition continues for a period in excess of 10 consecutive Business Days after (i) Tenant furnishes a notice to Landlord (the "**Abatement Notice**") stating that Tenant's inability to use the Premises is solely due to such condition, (ii) Tenant does not actually use or occupy the Premises during such period for the ordinary conduct of its business and (iii) such condition has not resulted from the negligence or misconduct of any Tenant Party, then Fixed Rent, Tenant's Tax Payment and Tenant's Operating Payment shall be abated on a per diem basis for the period commencing on the 11th Business Day after Tenant delivers the Abatement Notice to Landlord and ending on the earlier of (x) the date Tenant reoccupies any portion of the Premises, and (y) the date on which such condition is substantially remedied. "**Essential Service**" shall mean a service which Landlord is obligated under this Lease to provide to Tenant which if not provided shall (1) effectively deny access to the Premises, (2) threaten the health or safety of any occupants of the Premises or (3) prevent or materially and adversely restrict the usage of more than 25% of the Premises for the ordinary conduct of Tenant's business.

ARTICLE 11

INSURANCE; PROPERTY LOSS OR DAMAGE

Section 11.1 Tenant's Insurance. (a) Tenant, at its expense, shall obtain and keep in full force and effect during the Term:

(i) a policy of commercial general liability insurance on an occurrence basis against claims for personal injury, bodily injury, death and/or property damage occurring in or about the Building, under which Tenant is named as the insured and Landlord, Landlord's Agent and any Lessors and any Mortgagees whose names have been furnished to Tenant are named as additional insureds (the "**Insured Parties**"). Such insurance shall provide primary coverage without contribution from any other insurance carried by or for the benefit of the Insured Parties, and Tenant shall obtain blanket broad-form contractual liability coverage to insure its indemnity obligations set forth in **Article 25**. The minimum limits of liability applying exclusively to the Premises shall be a combined single limit with respect to each occurrence in an amount of not less than \$5,000,000; provided, however, that Landlord shall retain the right to require Tenant to increase such coverage from time to time to that amount of insurance which in Landlord's reasonable judgment is then being customarily required by landlords for similar office space in Comparable Buildings. The self insured retention for such policy shall not exceed \$10,000. Said insurance may be maintained by Tenant under a so-called "umbrella policy" covering the Premises as well as other premises of Tenant, provided that (i) Tenant shall furnish Landlord with evidence satisfactory to Landlord of the existence of such umbrella policy, (ii) such umbrella policy specifically includes the Premises, and (iii) the aforesaid minimum limits apply to each occurrence covered by such umbrella policy and afford the same protection as would be provided under an individual policy meeting the requirements of this Lease;

(ii) insurance against loss or damage by fire, and such other risks and hazards as are insurable under then available standard forms of "Special Form Causes of Loss" or "All Risk" property insurance policies with extended coverage, insuring Tenant's Property and all Alterations and improvements to the Premises (including the Initial Installations) to the extent such Alterations and improvements exceed the cost of the improvements typically performed in connection with the initial occupancy of tenants in the Building ("**Building Standard Installations**"), for the full insurable value thereof or replacement cost thereof, having a deductible amount, if any, not in excess of \$25,000;

(iii) during the performance of any Alteration, until completion thereof, Builder's Risk insurance on an "all risk" basis and on a completed value form including a Permission to Complete and Occupy endorsement, for full replacement value covering the interest of Landlord and Tenant (and their respective contractors and subcontractors) in all work incorporated in the Building and all materials and equipment in or about the Premises;

(iv) Workers' Compensation Insurance, as required by law;

(v) Business Interruption Insurance; and

(vi) such other insurance in such amounts as the Insured Parties may reasonably require from time to time.

(b) All insurance required to be carried by Tenant (i) shall contain a provision that (x) no act or omission of Tenant shall affect or limit the obligation of the insurance company to pay the amount of any loss sustained, and (y) such insurance shall be noncancellable and/or no material change in coverage shall be made thereto unless the Insured Parties receive 30 days' prior notice of the same, by certified mail, return receipt requested, and (ii) shall be effected under valid and enforceable policies issued by reputable insurers permitted to do

business in the State of New York and rated in Best's Insurance Guide, or any successor thereto as having a "Best's Rating" of "A-" or better and a "Financial Size Category" of at least "X" or better or, if such ratings are not then in effect, the equivalent thereof or such other financial rating as Landlord may at any time consider appropriate.

(c) On or prior to the Commencement Date, Tenant shall deliver to Landlord appropriate policies of insurance, including evidence of waivers of subrogation required to be carried pursuant to this **Article 11** and that the Insured Parties are named as additional insureds (the "**Policies**"). Evidence of each renewal or replacement of the Policies shall be delivered by Tenant to Landlord at least 10 days prior to the expiration of the Policies. In lieu of the Policies, Tenant may deliver to Landlord a certification from Tenant's insurance company (on the form currently designated "Acord 27" (Evidence of Property Insurance) and "Acord 25-S" (Certificate of Liability Insurance), or the equivalent, provided that attached thereto is an endorsement to Tenant's commercial general liability policy naming the Insured Parties as additional insureds) which shall be binding on Tenant's insurance company, and which shall expressly provide that such certification (i) conveys to the Insured Parties all the rights and privileges afforded under the Policies as primary insurance, and (ii) contains an unconditional obligation of the insurance company to advise all Insured Parties in writing by certified mail, return receipt requested, at least 30 days in advance of any termination of or change to the Policies that would affect the interest of any of the Insured Parties.

Section 11.2 Waiver of Subrogation. Landlord and Tenant shall each procure an appropriate clause in or endorsement to any property insurance covering the Real Property and personal property, fixtures and equipment located therein, wherein the insurer waives subrogation or consents to a waiver of right of recovery, and Landlord and Tenant agree not to make any claim against, or seek to recover from, the other for any loss or damage to its property or the property of others resulting from fire or other hazards to the extent covered by such property insurance; provided, however, that the release, discharge, exoneration and covenant not to sue contained herein shall be limited by and be coextensive with the terms and provisions of the waiver of subrogation or waiver of right of recovery. Tenant acknowledges that Landlord shall not carry insurance on, and shall not be responsible for, (i) damage to any Above Building Standard Installations, (ii) Tenant's Property, and (iii) any loss suffered by Tenant due to interruption of Tenant's business.

Section 11.3 Restoration. (a) If the Premises are damaged by fire or other casualty, or if the Building is damaged such that Tenant is deprived of reasonable access to the Premises, the damage shall be repaired by Landlord using reasonable diligence, to substantially the condition of the Premises prior to the damage, subject to the provisions of any Mortgage or Superior Lease, but Landlord shall have no obligation to repair or restore (i) Tenant's Property, or (ii) except as provided in **Section 11.3(b)**, any Alterations or improvements to the Premises to the extent such Alterations or improvements exceed Building Standard Installations ("**Above Building Standard Installations**"). So long as Tenant is not in default beyond applicable grace or notice provisions in the payment or performance of its obligations under this **Section 11.3**, and provided Tenant timely delivers to Landlord either Tenant's Restoration Payment (as hereinafter defined) or the Restoration Security (as hereinafter defined) or Tenant expressly waives any obligation of Landlord to repair or restore any of Tenant's Above Building Standard Installations, then until the restoration of the Premises is Substantially Completed or would have been Substantially Completed but for Tenant Delay, Fixed Rent, Tenant's Tax Payment and Tenant's Operating Payment shall be reduced in the proportion by which the area of the part of the Premises which is not usable (or accessible) and is not used by Tenant bears to the total area of the Premises. This **Article 11** constitutes an express agreement governing any case of

damage or destruction of the Premises or the Building by fire or other casualty, and Section 227 of the Real Property Law of the State of New York, which provides for such contingency in the absence of an express agreement, and any other law of like nature and purpose now or hereafter in force, shall have no application in any such case.

(b) As a condition precedent to Landlord's obligation to repair or restore any of Tenant's Above Building Standard Installations, Tenant shall (i) pay to Landlord upon demand a sum ("**Tenant's Restoration Payment**") equal to the amount, if any, by which (A) the cost, as estimated by a reputable independent contractor designated by Landlord, of repairing and restoring all Alterations and Initial Installations in the Premises to their condition prior to the damage, exceeds (B) the cost of restoring the Premises with Building Standard Installations, or (ii) furnish to Landlord security (the "**Restoration Security**") in form and amount reasonably acceptable to Landlord to secure Tenant's obligation to pay all costs in excess of restoring the Premises with Building Standard Installations. If Tenant shall fail to deliver to Landlord either (1) Tenant's Restoration Payment or the Restoration Security, as applicable, or (2) a waiver by Tenant, in form satisfactory to Landlord, of all of Landlord's obligations to repair or restore any of the Above Building Standard Installations, in either case within 25 days after Landlord's demand therefor, Landlord shall have no obligation to restore any Above Building Standard Installations and Tenant's abatement of Fixed Rent, Tenant's Tax Payment and Tenant's Operating Payment shall cease when the restoration of the Premises (other than any Above Building Standard Installations) is Substantially Complete.

Section 11.4 Landlord's Termination Right. Notwithstanding anything to the contrary contained in **Section 11.3**, if the Premises are totally damaged or are rendered wholly untenable, or if the Building shall be so damaged that, in Landlord's reasonable opinion, substantial alteration, demolition, or reconstruction of the Building shall be required (whether or not the Premises are so damaged or rendered untenable), then in either of such events, Landlord may, not later than 60 days following the date of the damage, terminate this Lease by notice to Tenant, provided that if the Premises are not damaged, Landlord may not terminate this Lease unless Landlord similarly terminates the leases of other tenants in the Building aggregating at least 50% of the portion of the Building occupied for office purposes immediately prior to such damage. If this Lease is so terminated, (a) the Term shall expire upon the 30th day after such notice is given, (b) Tenant shall vacate the Premises and surrender the same to Landlord, (c) Tenant's liability for Rent shall cease as of the date of the damage, and (d) any prepaid Rent for any period after the date of the damage shall be refunded by Landlord to Tenant.

Section 11.5 Tenant's Termination Right. If the Premises are totally damaged and are thereby rendered wholly untenable, or if the Building shall be so damaged that Tenant is deprived of reasonable access to the Premises, and if Landlord elects to restore the Premises, Landlord shall, within 60 days following the date of the damage, cause a contractor or architect selected by Landlord to give notice (the "**Restoration Notice**") to Tenant of the date by which such contractor or architect estimates the restoration of the Premises (excluding any Above Building Standard Installations) shall be Substantially Completed. If such date, as set forth in the Restoration Notice, is more than 15 months from the date of such damage, then Tenant shall have the right to terminate this Lease by giving notice (the "**Termination Notice**") to Landlord not later than 30 days following delivery of the Restoration Notice to Tenant. If Tenant delivers a Termination Notice, this Lease shall be deemed to have terminated as of the date of the giving of the Termination Notice, in the manner set forth in the second sentence of **Section 11.4**.

Section 11.6 Final 18 Months. Notwithstanding anything to the contrary in this **Article 11**, if any damage during the final 18 months of the Term renders the Premises wholly untenable, either Landlord or Tenant may terminate this Lease by notice to the other party within 30 days after the occurrence of such damage and this Lease shall expire on the 30th day after the date of such notice. For purposes of this **Section 11.6**, the Premises shall be deemed wholly untenable if Tenant shall be precluded from using more than 50% of the Premises for the conduct of its business and Tenant's inability to so use the Premises is reasonably expected to continue for more than 90 days.

Section 11.7 Landlord's Liability. Any Building employee to whom any property shall be entrusted by or on behalf of Tenant shall be deemed to be acting as Tenant's agent with respect to such property and neither Landlord nor its agents shall be liable for any damage to such property, or for the loss of or damage to any property of Tenant by theft or otherwise. None of the Insured Parties shall be liable for any injury or damage to persons or property or interruption of Tenant's business resulting from fire or other casualty, any damage caused by other tenants or persons in the Building or by construction of any private, public or quasi-public work, or any latent defect in the Premises or in the Building (except that Landlord shall be required to repair the same to the extent provided in **Article 6**). No penalty shall accrue for delays which may arise by reason of adjustment of fire insurance on the part of Landlord or Tenant, or for any Unavoidable Delays arising from any repair or restoration of any portion of the Building, provided that Landlord shall use reasonable efforts to minimize interference with Tenant's use and occupancy of the Premises during the performance of any such repair or restoration.

ARTICLE 12

EMINENT DOMAIN

Section 12.1 Taking.

(a) **Total Taking.** If all or substantially all of the Real Property, the Building or the Premises shall be acquired or condemned for any public or quasi-public purpose (a "Taking"), this Lease shall terminate and the Term shall end as of the date of the vesting of title and Rent shall be prorated and adjusted as of such date.

(b) **Partial Taking.** Upon a Taking of only a part of the Real Property, the Building or the Premises then, except as hereinafter provided in this **Article 12**, this Lease shall continue in full force and effect, provided that from and after the date of the vesting of title, Fixed Rent and Tenant's Proportionate Share shall be modified to reflect the reduction of the Premises and/or the Building as a result of such Taking.

(c) **Landlord's Termination Right.** Whether or not the Premises are affected, Landlord may, by notice to Tenant, within 60 days following the date upon which Landlord receives notice of the Taking of all or a significant portion of the Real Property, the Building or the Premises, terminate this Lease, provided that Landlord elects to terminate leases (including this Lease) affecting at least 50% of the rentable area of the Building.

(d) **Tenant's Termination Right.** If the part of the Real Property so Taken contains more than 20% of the total area of the Premises occupied by Tenant immediately prior to such Taking, or if, by reason of such Taking, Tenant no longer has reasonable means of

access to the Premises, Tenant may terminate this Lease by notice to Landlord given within 30 days following the date upon which Tenant is given notice of such Taking. If Tenant so notifies Landlord, this Lease shall end and expire upon the 30th day following the giving of such notice. If a part of the Premises shall be so Taken and this Lease is not terminated in accordance with this **Section 12.1** Landlord, without being required to spend more than it collects as an award, shall, subject to the provisions of any Mortgage or Superior Lease, restore that part of the Premises not so Taken to a self-contained rental unit substantially equivalent (with respect to character, quality, appearance and services) to that which existed immediately prior to such Taking, excluding Tenant's Property and Above Building Standard Installations.

(e) **Apportionment of Rent.** Upon any termination of this Lease pursuant to the provisions of this **Article 12**, Rent shall be apportioned as of, and shall be paid or refunded up to and including, the date of such termination.

Section 12.2 Awards. Upon any Taking, Landlord shall receive the entire award for any such Taking, and Tenant shall have no claim against Landlord or the condemning authority for the value of any unexpired portion of the Term or Tenant's Alterations; and Tenant hereby assigns to Landlord all of its right in and to such award. Nothing contained in this **Article 12** shall be deemed to prevent Tenant from making a separate claim in any condemnation proceedings for the then value of any Tenant's Property or Above Building Standard Installations included in such Taking and for any moving expenses, provided any such award is in addition to, and does not result in a reduction of, the award made to Landlord.

Section 12.3 Temporary Taking. If all or any part of the Premises is Taken temporarily during the Term for any public or quasi-public use or purpose, Tenant shall give prompt notice to Landlord and the Term shall not be reduced or affected in any way and Tenant shall continue to pay all Rent payable by Tenant without reduction or abatement and to perform all of its other obligations under this Lease, except to the extent prevented from doing so by the condemning authority, and Tenant shall be entitled to receive any award or payment from the condemning authority for such use, which shall be received, held and applied by Tenant as a trust fund for payment of the Rent falling due.

ARTICLE 13

ASSIGNMENT AND SUBLETTING

Section 13.1 Consent Requirements.

(a) **No Transfers.** Except as expressly set forth herein, Tenant shall not assign, mortgage, pledge, encumber, or otherwise transfer this Lease, whether by operation of law or otherwise, and shall not sublet, or permit, or suffer the Premises or any part thereof to be used or occupied by others (whether for desk space, mailing privileges or otherwise), without Landlord's prior consent in each instance. Any assignment, sublease, mortgage, pledge, encumbrance or transfer in contravention of the provisions of this **Article 13** shall be void and shall constitute an Event of Default.

(b) **Collection of Rent.** If, without Landlord's consent, this Lease is assigned, or any part of the Premises is sublet or occupied by anyone other than Tenant or this Lease is encumbered (by operation of law or otherwise), Landlord may collect rent from the assignee, subtenant or occupant, and apply the net amount collected to the Rent herein

reserved. No such collection shall be deemed a waiver of the provisions of this **Article 13**, an acceptance of the assignee, subtenant or occupant as tenant, or a release of Tenant from the performance of Tenant's covenants hereunder, and in all cases Tenant shall remain fully liable for its obligations under this Lease.

(c) **Further Assignment/Subletting.** Landlord's consent to any assignment or subletting shall not relieve Tenant from the obligation to obtain Landlord's consent to any further assignment or subletting. In no event shall any permitted subtenant assign or encumber its sublease or further sublet any portion of its sublet space, or otherwise suffer or permit any portion of the sublet space to be used or occupied by others.

Section 13.2 Tenant's Notice. If Tenant desires to assign this Lease or sublet all or any portion of the Premises, Tenant shall give notice thereof to Landlord, which shall be accompanied by (a) with respect to an assignment of this Lease, a fully-executed copy of the assignment and assumption agreement, and (b) with respect to a sublet of all or a part of the Premises, a description of the portion of the Premises to be sublet, and a copy of the fully-executed sublease agreement. Such notice shall be deemed an irrevocable offer from Tenant to Landlord of the right, at Landlord's option, (1) to terminate this Lease with respect to such space as Tenant proposes to sublease (the "**Partial Space**"), provided the term of the proposed sublease expires less than 12 months before the Expiration Date, upon the terms and conditions hereinafter set forth, or (2) if the proposed transaction is an assignment of this Lease or a subletting of 75% or more of the rentable square footage of the Premises expiring less than 12 months before the Expiration Date, to terminate this Lease with respect to the entire Premises. Such option may be exercised by notice from Landlord to Tenant within 30 days after delivery of Tenant's notice along with the applicable documentation and information stated above. If Landlord exercises its option to terminate all or a portion of this Lease, (a) this Lease shall end and expire with respect to all or a portion of the Premises, as the case may be, on the date that such assignment or sublease was to commence, provided that such date is in no event less than 90 days after the date of the above notice unless Landlord agrees to an earlier date, (b) Rent shall be apportioned, paid or refunded as of such date, (c) Tenant, upon Landlord's request, shall enter into an amendment of this Lease ratifying and confirming such total or partial termination, and setting forth any appropriate modifications to the terms and provisions hereof, and (d) Landlord shall be free to lease the Premises (or any part thereof) to Tenant's prospective assignee or subtenant. Tenant shall pay all costs to make the Partial Space a self-contained rental unit and install any required Building corridors unless the fully-executed sublease agreement provides that the subtenant shall pay all such costs, in which case Landlord shall be obligated to pay such costs.

Section 13.3 (a) Landlord's Leaseback. If Landlord receives a notice from Tenant as described in **Section 13.2** with respect to a sublease for less than the remainder of the Term, Landlord or its designee may, at its option, in lieu of exercising the option described in **Section 13.2** but subject to the same 30-day period, sublease from Tenant the space described in Tenant's notice (such space being hereafter referred to as the "**Leaseback Space**"). If Landlord exercises its option to sublet the Leaseback Space, such sublease shall be at a rental rate equal to the product of the lesser of (x) the rent per rentable square foot then payable pursuant to this Lease, and (y) the rent per rentable square foot contained in the proposed and executed sublease agreement, **multiplied** by the rentable square foot area of the Leaseback Space; shall be for the same term as that of the proposed sublease; and shall:

(i) be expressly subject to all of the covenants, terms and conditions of this Lease except such as are irrelevant or inapplicable, and except as expressly set forth in this **Article 13** to the contrary;

(ii) give the subtenant the unqualified and unrestricted right, without Tenant's consent, to assign such sublease or any interest therein and/or to sublet all or any portion of the space covered by such sublease and to make alterations and improvements in the space covered by such sublease;

(iii) provide that any assignee or further subtenant of Landlord or its designee, may, at Landlord's option, be permitted to make alterations and decorations in such space and that any or all of such alterations and decorations may be removed by such assignee or subtenant, at its option, prior to or upon the expiration or other termination of such sublease, provided that such assignee or subtenant shall, at its expense, repair any damage caused by such removal; and

(iv) provide that (A) the parties to such sublease expressly negate any intention that the sublease estate be merged with any other estate held by either of such parties, (B) any assignment or sublease by Landlord or its designee (as the subtenant) may be for any purpose or purposes that Landlord, in its sole discretion, shall deem appropriate, (C) Tenant shall, at its sole cost and expense, at all times provide and permit reasonably appropriate means of ingress to and egress from such space so sublet by Tenant to Landlord or its designee, (D) Landlord may, at Tenant's expense, make such alterations as may be required or deemed necessary by Landlord to physically separate the Leaseback Space from the balance of the Premises and to comply with any Requirements or insurance requirements relating to such separation, and (E) at the expiration of the term of such sublease, Tenant will accept the Leaseback Space in its then existing condition, subject to the obligations of the subtenant to make such repairs as may be necessary to preserve such premises in good order and condition.

(b) **Obligations Re: Leaseback Space.** If Landlord exercises its option to sublet the Leaseback Space:

(i) Performance by Landlord, or its designee, under a sublease of the Leaseback Space shall be deemed performance by Tenant of any similar obligation under this Lease and Tenant shall not be liable for any default under this Lease or deemed to be in default hereunder if such default is occasioned by or arises from any act or omission of the subtenant pursuant such sublease;

(ii) Tenant shall have no obligation, at the expiration or earlier termination of the Term, to remove any alteration, installation or improvement made in the Leaseback Space by Landlord (or Landlord's designee); and

(iii) Any consent required of Tenant, as Landlord under the sublease, shall be deemed granted if consent with respect thereto is granted by Landlord under this Lease, and any failure of Landlord (or its designee) to comply with the provisions of the sublease other than with respect to the payment of Rent shall not constitute a default thereunder or hereunder if Landlord shall have consented to such non-compliance.

Section 13.4 Conditions to Assignment/Subletting. (a) If Landlord does not exercise either of Landlord's options provided under **Sections 13.2** and **13.3**, and provided no Event of Default then exists, Landlord's consent to the proposed assignment or subletting shall not be unreasonably withheld or delayed. Such consent shall be granted or denied within 30 days after delivery to Landlord of (i) the documentation and information required under **Section 13.2**, (ii) a true and complete statement reasonably detailing the identity of the proposed assignee or subtenant ("**Transferee**"), the nature of its business and its proposed use of the Premises, (iii) current financial information with respect to the Transferee, including its most recent financial statements, and (iv) any other information Landlord may reasonably request, provided that:

(A) in Landlord's reasonable judgment, the Transferee is engaged in a business or activity, and the Premises will be used in a manner, which (1) is in keeping with the then standards of the Building, (2) is for the Permitted Uses, and (3) does not violate any restrictions set forth in this Lease, any Mortgage or Superior Lease or any negative covenant as to use of the Premises required by any other lease in the Building;

(B) the Transferee is reputable with sufficient financial means to perform all of its obligations under this Lease or the sublease, as the case may be;

(C) if Landlord has, or reasonably expects to have within 6 months thereafter, comparable space available in the Building, neither the Transferee nor any person or entity which, directly or indirectly, controls, is controlled by, or is under common control with, the Transferee is then an occupant of the Building;

(D) the Transferee is not a person or entity (or affiliate of a person or entity) with whom Landlord is then or has been within the prior 6 months negotiating in connection with the rental of space in the Building;

(E) there shall be not more than 2 subtenants in each floor of the Premises;

(F) Tenant shall, upon demand, reimburse Landlord for all reasonable expenses incurred by Landlord in connection with such assignment or sublease, including any investigations as to the acceptability of the Transferee and all legal costs reasonably incurred in connection with the granting of any requested consent;

(G) Tenant has not and shall not publicize the availability of the Premises or list the Premises to be sublet or assigned with a broker, agent or other entity or otherwise offer the Premises for subletting in any case at a rental rate of less than the fixed rent and escalation rent at which Landlord is then offering to rent other space in the Building but the foregoing provision shall not be deemed to prohibit Tenant from responding to brokers' solicitations and any other inquiries regarding the proposed rental rate or from negotiating a sublease at a lesser rate of rent and consummating the same insofar as it may be permitted under the provisions of this **Article 13**; and

(H) the Transferee shall not be entitled, directly or indirectly, to diplomatic or sovereign immunity, regardless of whether the Transferee agrees to waive such diplomatic or sovereign immunity, and shall be subject to the service of process in, and the jurisdiction of the courts of, the City and State of New York.

(b) With respect to each and every subletting and/or assignment approved by Landlord under the provisions of this Lease:

(i) the form of the proposed assignment or sublease shall be reasonably satisfactory to Landlord;

(ii) no sublease shall be for a term ending later than one day prior to the Expiration Date;

(iii) if an Event of Default occurs prior to the effective date of such assignment or subletting, then Landlord's consent thereto, if previously granted, shall be immediately deemed revoked without further notice to Tenant, and if such assignment or subletting would have been permitted without Landlord's consent pursuant to **Section 13.7**, such permission shall be void and without force and effect, and in either such case, any such assignment or subletting shall constitute a further Event of Default hereunder; and

(iv) each sublease shall be subject and subordinate to this Lease and to the matters to which this Lease is or shall be subordinate; and Tenant and each Transferee shall be deemed to have agreed that upon the occurrence and during the continuation of an Event of Default hereunder, Tenant has hereby assigned to Landlord, and Landlord may, at its option, accept such assignment of, all right, title and interest of Tenant as sublandlord under such sublease, together with all modifications, extensions and renewals thereof then in effect and such Transferee shall, at Landlord's option, attorn to Landlord pursuant to the then executory provisions of such sublease, except that Landlord shall not be (A) liable for any previous act or omission of Tenant under such sublease, (B) subject to any counterclaim, offset or defense not expressly provided in such sublease, which theretofore accrued to such Transferee against Tenant, (C) bound by any previous modification of such sublease not consented to by Landlord or by any prepayment of more than one month's rent, (D) bound to return such Transferee's security deposit, if any, except to the extent Landlord shall receive actual possession of such deposit and such Transferee shall be entitled to the return of all or any portion of such deposit under the terms of its sublease, or (E) obligated to make any payment to or on behalf of such Transferee, or to perform any work in the subleased space or the Building, or in any way to prepare the subleased space for occupancy, beyond Landlord's obligations under this Lease. The provisions of this **Section 13.4(b)(iv)** shall be self-operative, and no further instrument shall be required to give effect to this provision, provided that the Transferee shall execute and deliver to Landlord any instruments Landlord may reasonably request to evidence and confirm such subordination and attornment.

Section 13.5 Binding on Tenant; Indemnification of Landlord. Notwithstanding any assignment or subletting or any acceptance of rent by Landlord from any Transferee, Tenant shall remain fully liable for the payment of all Rent due and for the performance of all the covenants, terms and conditions contained in this Lease on Tenant's part to be observed and performed, and any default under any term, covenant or condition of this Lease by any Transferee or anyone claiming under or through any Transferee shall be deemed to be a default under this Lease by Tenant. Tenant shall indemnify, defend, protect and hold harmless Landlord from and against any and all Losses resulting from any claims that may be made against Landlord by the Transferee or anyone claiming under or through any Transferee or by any brokers or other persons or entities claiming a commission or similar compensation in connection with the proposed assignment or sublease, irrespective of whether Landlord shall give or decline to give its consent to any proposed assignment or sublease, or if Landlord shall exercise any of its options under this **Article 13**.

Section 13.6 Tenant's Failure to Complete. If Landlord consents to a proposed assignment or sublease and such assignment or sublease fails to become effective within 90 days after giving of such consent, then Tenant shall again comply with all of the provisions and conditions of **Sections 13.2, 13.3 and 13.4** before assigning this Lease or subletting all or part of the Premises.

Section 13.7 Profits. If Tenant enters into any assignment or sublease permitted hereunder or consented to by Landlord, Tenant shall, within 60 days of Landlord's consent to such assignment or sublease, deliver to Landlord a list of Tenant's reasonable third-party brokerage fees, legal fees and architectural fees paid or to be paid in connection with such transaction and, in the case of any sublease, any actual costs incurred by Tenant in separately demising the sublet space (collectively, "**Transaction Costs**"), together with a list of all of Tenant's Property to be transferred to such Transferee. The Transaction Costs shall be amortized, on a straight-line basis, over the term of any sublease. Tenant shall deliver to Landlord evidence of the payment of any Transaction Costs within 30 days after the same are paid (and if Tenant shall fail to do so, no such fees or costs for which Tenant shall have failed to provide evidence of payment shall qualify as Transaction Costs). In consideration of such assignment or subletting, Tenant shall pay to Landlord:

(a) In the case of an assignment, on the effective date of the assignment, 50% of all sums and other consideration paid to Tenant by the Transferee for or by reason of such assignment (including sums paid for the sale or rental of Tenant's Property, less the then fair market or rental value thereof, as reasonably determined by Landlord) after first deducting the Transaction Costs; or

(b) In the case of a sublease, 50% of any consideration payable under the sublease to Tenant by the Transferee which exceeds on a per square foot basis the Fixed Rent and Additional Rent accruing during the term of the sublease in respect of the sublet space (together with any sums paid for the sale or rental of Tenant's Property, less the then fair market or rental value thereof, as reasonably determined by Landlord) after first deducting the monthly amortized amount of Transaction Costs. The sums payable under this clause shall be paid by Tenant to Landlord monthly as and when paid by the subtenant to Tenant.

Section 13.8 Transfers.

(a) **Related Entities.** If Tenant is a legal entity, the transfer (by one or more transfers), directly or indirectly, by operation of law or otherwise, of a majority of the stock or other beneficial ownership interest in Tenant (collectively "**Ownership Interests**") other than to a Related Entity shall be deemed a voluntary assignment of this Lease (the holder of a majority of the Ownership Interests in Tenant on the Effective Date is hereinafter referred to as the "**Parent Entity**"); provided, however, that the provisions of this **Article 13** shall not apply to the transfer of Ownership Interests in Tenant if and so long as Tenant is publicly traded on a nationally recognized stock exchange. For purposes of this **Article**, the term "transfers" shall be deemed to include (x) the issuance of new Ownership Interests which results in a majority of the Ownership Interests in Tenant being held by a person or entity which does not hold a majority of the Ownership Interests in Tenant on the Effective Date, and (y) except as provided below, the sale or transfer of all or substantially all of the assets of Tenant in one or more transactions and the merger or consolidation of Tenant into or with another business entity. The provisions of **Section 13.1** shall not apply to transactions with a business entity into or with which Tenant is merged or consolidated or to which substantially all of Tenant's assets are transferred or to

which a majority of the Ownership Interests in Tenant is transferred so long as (i) such transfer was made for a legitimate independent business purpose and not for the purpose of transferring this Lease, (ii) the successor to Tenant or the Parent Entity, as the case may be, has a net worth computed in accordance with generally accepted accounting principles at least equal to the net worth of Tenant or the Parent Entity, as the case may be, immediately prior to such merger, consolidation or transfer, and (iii) proof satisfactory to Landlord of such net worth is delivered to Landlord at least 10 days prior to the effective date of any such transaction. Tenant may also, upon prior notice to Landlord, permit any business entity which controls, is controlled by, or is under common control with the original named Tenant (a "**Related Entity**") to sublet or use all or part of the Premises for any Permitted Use, provided the Related Entity is in Landlord's reasonable judgment of a character and engaged in a business which is in keeping with the standards for the Building and for so long as such entity remains a Related Entity. Such sublease shall not be deemed to vest in any such Related Entity any right or interest in this Lease nor shall it relieve, release, impair or discharge any of Tenant's obligations hereunder. For the purposes hereof, "control" shall be deemed to mean ownership of not less than 50% of all of the Ownership Interests of such corporation or other business entity. Notwithstanding the foregoing, Tenant shall have no right to assign this Lease or sublease all or any portion of the Premises without Landlord's consent pursuant to this **Section 13.8** if Tenant is not the initial Tenant herein named or a person or entity who acquired Tenant's interest in this Lease in a transaction approved by Landlord.

(b) **Applicability.** The limitations set forth in this **Section 13.8** shall apply to Transferee(s) and guarantor(s) of this Lease, if any, and any transfer by any such entity in violation of this **Section 13.8** shall be a transfer in violation of **Section 13.1**.

(c) **Modifications, Takeover Agreements.** Any modification, amendment or extension of a sublease and/or any other agreement by which a landlord of a building other than the Building (or its affiliate) agrees to assume the obligations of Tenant under this Lease shall be deemed a sublease for the purposes of **Section 13.1** hereof.

Section 13.9 Assumption of Obligations. No assignment or transfer shall be effective unless and until the Transferee executes, acknowledges and delivers to Landlord an agreement in form and substance reasonably satisfactory to Landlord whereby the assignee (a) assumes Tenant's obligations under this Lease and (b) agrees that, notwithstanding such assignment or transfer, the provisions of **Section 13.1** hereof shall be binding upon it in respect of all future assignments and transfers.

Section 13.10 Tenant's Liability. The joint and several liability of Tenant and any successors-in-interest of Tenant and the due performance of Tenant's obligations under this Lease shall not be discharged, released or impaired by any agreement or stipulation made by Landlord, or any grantee or assignee of Landlord, extending the time, or modifying any of the terms and provisions of this Lease, or by any waiver or failure of Landlord, or any grantee or assignee of Landlord, to enforce any of the terms and provisions of this Lease.

Section 13.11 Listings in Building Directory. The listing of any name other than that of Tenant on the doors of the Premises, the Building directory or elsewhere shall not vest any right or interest in this Lease or in the Premises, nor be deemed to constitute Landlord's consent to any assignment or transfer of this Lease or to any sublease of the Premises or to the use or occupancy thereof by others. Any such listing shall constitute a privilege revocable in Landlord's discretion by notice to Tenant.

Section 13.12 Lease Disaffirmance or Rejection. If at any time after an assignment by Tenant named herein, this Lease is not affirmed or is rejected in any bankruptcy proceeding or any similar proceeding, or upon a termination of this Lease due to any such proceeding, Tenant named herein, upon request of Landlord given after such disaffirmance, rejection or termination (and actual notice thereof to Landlord in the event of a disaffirmance or rejection or in the event of termination other than by act of Landlord), shall (a) pay to Landlord all Rent and other charges due and owing by the assignee to Landlord under this Lease to and including the date of such disaffirmance, rejection or termination, and (b) as "tenant," enter into a new lease of the Premises with Landlord for a term commencing on the effective date of such disaffirmance, rejection or termination and ending on the Expiration Date, at the same Rent and upon the then executory terms, covenants and conditions contained in this Lease, except that (i) the rights of Tenant named herein under the new lease shall be subject to the possessory rights of the assignee under this Lease and the possessory rights of any persons or entities claiming through or under such assignee or by virtue of any statute or of any order of any court, (ii) such new lease shall require all defaults existing under this Lease to be cured by Tenant named herein with due diligence, and (iii) such new lease shall require Tenant named herein to pay all Rent which, had this Lease not been so disaffirmed, rejected or terminated, would have become due under the provisions of this Lease after the date of such disaffirmance, rejection or termination with respect to any period prior thereto. If Tenant named herein defaults in its obligations to enter into such new lease for a period of 10 days after Landlord's request, then, in addition to all other rights and remedies by reason of default, either at law or in equity, Landlord shall have the same rights and remedies against Tenant named herein as if it had entered into such new lease and such new lease had thereafter been terminated as of the commencement date thereof by reason of Tenant's default thereunder.

ARTICLE 14

ACCESS TO PREMISES

Section 14.1 Landlord's Access. (a) Landlord, Landlord's agents and utility service providers servicing the Building may erect, use and maintain concealed ducts, pipes and conduits in and through the Premises provided such use does not cause the usable area of the Premises to be reduced beyond a *de minimis* amount. Landlord shall promptly repair any damage to the Premises caused by any work performed pursuant to this **Article 14**.

(b) Landlord, any Lessor or Mortgagee and any other party designated by Landlord and their respective agents shall have the right to enter the Premises at all reasonable times, upon reasonable notice (which notice may be oral) except in the case of emergency, to examine the Premises, to show the Premises to prospective purchasers, Mortgagees, Lessors or, during the last 15 months of the Term, tenants and their respective agents and representatives or others and to perform Restorative Work to the Premises or the Building.

(c) All parts (except surfaces facing the interior of the Premises) of all walls, windows and doors bounding the Premises, all balconies, terraces and roofs adjacent to the Premises, all space in or adjacent to the Premises used for shafts, stacks, stairways, mail chutes, conduits and other mechanical facilities, Building Systems, Building facilities and Common Areas are not part of the Premises, and Landlord shall have the use thereof and access thereto through the Premises for the purposes of Building operation, maintenance, alteration and repair.

Section 14.2 Building Name. Landlord has the right at any time to change the name, number or designation by which the Building is commonly known.

Section 14.3 Light and Air. If at any time any windows of the Premises are temporarily darkened or covered over by reason of any Restorative Work, any of such windows are permanently darkened or covered over due to any Requirement or there is otherwise a diminution of light, air or view by another structure which may hereafter be erected (whether or not by Landlord), Landlord shall not be liable for any damages and Tenant shall not be entitled to any compensation or abatement of any Rent, nor shall the same release Tenant from its obligations hereunder or constitute an actual or constructive eviction. Landlord shall use reasonable efforts to notify Tenant in advance of any such darkening or covering over, provided Landlord shall have no liability in the event that Landlord shall fail to do so.

ARTICLE 15

DEFAULT

Section 15.1 Tenant's Defaults. Each of the following events shall be an "Event of Default" hereunder:

(a) Tenant fails to pay when due any installment of Rent and such default shall continue for 5 days after notice of such default is given to Tenant, except that if Landlord shall have given two such notices of default in the payment of any Rent in any 12-month period, Tenant shall not be entitled to any further notice of its delinquency in the payment of any Rent or an extended period in which to make payment until such time as 12 consecutive months shall have elapsed without Tenant having failed to make any such payment when due, and the occurrence of any default in the payment of any Rent within such 12-month period after the giving of 2 such notices shall constitute an Event of Default; or

(b) Tenant fails to observe or perform any other term, covenant or condition of this Lease and such failure continues for more than 30 days (10 days with respect to a default under **Article 3**) after notice by Landlord to Tenant of such default, or if such default (other than a default under **Article 3**) is of a nature that it cannot be completely remedied within 30 days, failure by Tenant to commence to remedy such failure within said 30 days, and thereafter diligently prosecute to completion all steps necessary to remedy such default, provided in all events the same is completed within 120 days; or

(c) if Landlord applies or retains any part of the security held by it hereunder, and Tenant fails to deposit with Landlord the amount so applied or retained by Landlord, or to provide Landlord with a replacement Letter of Credit (as hereinafter defined), if applicable, within 5 Business Days after notice by Landlord to Tenant stating the amount applied or retained; or

(d) Tenant files a voluntary petition in bankruptcy or insolvency, or is adjudicated a bankrupt or insolvent, or files any petition or answer seeking any reorganization, liquidation, dissolution or similar relief under any present or future federal bankruptcy act or any other present or future applicable federal, state or other statute or law, or makes an assignment for the benefit of creditors or seeks or consents to or acquiesces in the appointment of any trustee, receiver, liquidator or other similar official for Tenant or for all or any part of Tenant's property; or

(e) a court of competent jurisdiction shall enter an order, judgment or decree adjudicating Tenant bankrupt, or appointing a trustee, receiver or liquidator of Tenant, or of the whole or any substantial part of its property, without the consent of Tenant, or approving a petition filed against Tenant seeking reorganization or arrangement of Tenant under the bankruptcy laws of the United States, as now in effect or hereafter amended, or any state thereof, and such order, judgment or decree shall not be vacated or set aside or stayed within sixty (60) days from the date of entry thereof; or

(f) if Guarantor shall fail to perform any of its obligations when due under the Guaranty of Lease from the Guarantor in favor of Landlord, guarantying the payment and performance by Tenant of its obligations under this Lease; or

(g) Guarantor does not, or is unable to, or admits in writing its inability to, pay its debts as they become due or is subject to the filing of a petition, case or proceeding in bankruptcy.

Upon the occurrence of any one or more of such Events of Default, Landlord may, at its sole option, give to Tenant 3 days' notice of cancellation of this Lease (or of Tenant's possession of the Premises), in which event this Lease and the Term (or Tenant's possession of the Premises) shall terminate (whether or not the Term shall have commenced) with the same force and effect as if the date set forth in the notice was the Expiration Date stated herein; and Tenant shall then quit and surrender the Premises to Landlord, but Tenant shall remain liable for damages as provided in this **Article 15**. Any notice of cancellation of the Term (or Tenant's possession of the Premises) may be given simultaneously with any notice of default given to Tenant.

Section 15.2 Landlord's Remedies.

(a) **Possession/Reletting.** If any Event of Default occurs and this Lease and the Term, or Tenant's right to possession of the Premises, terminate as provided in **Section 15.1**:

(i) **Surrender of Possession.** Tenant shall quit and surrender the Premises to Landlord, and Landlord and its agents may immediately, or at any time after such termination, re-enter the Premises or any part thereof, without notice, either by summary proceedings, or by any other applicable action or proceeding, or by force (to the extent permitted by law) or otherwise in accordance with applicable legal proceedings (without being liable to indictment, prosecution or damages therefor), and may repossess the Premises and dispossess Tenant and any other persons or entities from the Premises and remove any and all of their property and effects from the Premises.

(ii) **Landlord's Reletting.** Landlord, at Landlord's option, may relet all or any part of the Premises from time to time, either in the name of Landlord or otherwise, to such tenant or tenants, for any term ending before, on or after the Expiration Date, at such rental and upon such other conditions (which may include concessions and free rent periods) as Landlord, in its sole discretion, may determine. Landlord shall have no obligation to accept any tenant offered by Tenant and shall not be liable for failure to relet or, in the event of any such reletting, for failure to collect any rent due upon any such reletting; and no such failure shall relieve Tenant of, or otherwise affect, any liability under this Lease. However, to the extent required by law, Landlord shall use reasonable efforts to mitigate its damages but shall not be

required to divert prospective tenants from any other portions of the Building. Landlord, at Landlord's option, may make such alterations, decorations and other physical changes in and to the Premises as Landlord, in its sole discretion, considers advisable or necessary in connection with such reletting or proposed reletting, without relieving Tenant of any liability under this Lease or otherwise affecting any such liability.

(b) **Tenant's Waiver.** Tenant, on its own behalf and on behalf of all persons or entities claiming through or under Tenant, including all creditors, hereby waives all rights which Tenant and all such persons or entities might otherwise have under any Requirement (i) to the service of any notice of intention to re-enter or to institute legal proceedings, (ii) to redeem, or to re-enter or repossess the Premises, or (iii) to restore the operation of this Lease, after (A) Tenant shall have been dispossessed by judgment or by warrant of any court or judge, (B) any re-entry by Landlord, or (C) any expiration or early termination of the term of this Lease, whether such dispossession, re-entry, expiration or termination shall be by operation of law or pursuant to the provisions of this Lease. The words "re-enter," "re-entry" and "re-entered" as used in this Lease shall not be deemed to be restricted to their technical legal meanings.

(c) **Tenant's Breach.** Upon the breach or threatened breach by Tenant, or any persons or entities claiming through or under Tenant, of any term, covenant or condition of this Lease, Landlord shall have the right to enjoin such breach and to invoke any other remedy allowed by law or in equity as if re-entry, summary proceedings and other special remedies were not provided in this Lease for such breach. The rights to invoke the remedies set forth above are cumulative and shall not preclude Landlord from invoking any other remedy allowed at law or in equity.

Section 15.3 Landlord's Damages.

(a) **Amount of Damages.** If this Lease and the Term, or Tenant's right to possession of the Premises, terminate as provided in **Section 15.1**, then:

(i) Tenant shall pay to Landlord all items of Rent payable under this Lease by Tenant to Landlord prior to the date of termination;

(ii) Landlord may retain all monies, if any, paid by Tenant to Landlord, whether as prepaid Rent, a security deposit or otherwise, which monies, to the extent not otherwise applied to amounts due and owing to Landlord, shall be credited by Landlord against any damages payable by Tenant to Landlord;

(iii) Tenant shall pay to Landlord, in monthly installments, on the days specified in this Lease for payment of installments of Fixed Rent, any Deficiency; it being understood that Landlord shall be entitled to recover the Deficiency from Tenant each month as the same shall arise, and no suit to collect the amount of the Deficiency for any month, shall prejudice Landlord's right to collect the Deficiency for any subsequent month by a similar proceeding; and

(iv) whether or not Landlord shall have collected any monthly Deficiency, Tenant shall pay to Landlord, on demand, in lieu of any further Deficiency and as liquidated and agreed final damages, a sum equal to the amount by which the Rent for the period which otherwise would have constituted the unexpired portion of the Term (assuming the Additional Rent during such period to be the same as was payable for the year immediately preceding such termination or re-entry, increased in each succeeding year by 4% (on a compounded

basis)) exceeds the then fair and reasonable rental value of the Premises, for the same period (with both amounts being discounted to present value at a rate of interest equal to 2% below the then Base Rate) less the aggregate amount of Deficiencies theretofore collected by Landlord pursuant to the provisions of **Section 15.3(a)(iii)** for the same period. If, before presentation of proof of such liquidated damages to any court, commission or tribunal, the Premises, or any part thereof, shall have been relet by Landlord for the period which otherwise would have constituted the unexpired portion of the Term, or any part thereof, the amount of rent reserved upon such reletting shall be deemed *prima facie*, to be the fair and reasonable rental value for the part or the whole of the Premises so relet during the term of the reletting.

(b) **Reletting.** If the Premises, or any part thereof, shall be relet together with other space in the Building, the rents collected or reserved under any such reletting and the expenses of any such reletting shall be equitably apportioned for the purposes of this **Section 15.3**. Tenant shall not be entitled to any rents collected or payable under any reletting, whether or not such rents exceeds the Fixed Rent reserved in this Lease. Nothing contained in **Article 15** shall be deemed to limit or preclude the recovery by Landlord from Tenant of the maximum amount allowed to be obtained as damages by any Requirement, or of any sums or damages to which Landlord may be entitled in addition to the damages set forth in this **Section 15.3**.

Section 15.4 Interest. If any payment of Rent is not paid when due, interest shall accrue on such payment, from the date such payment became due until paid at the Interest Rate. Tenant acknowledges that late payment by Tenant of Rent will cause Landlord to incur costs not contemplated by this Lease, the exact amount of such costs being extremely difficult and impracticable to fix. Such costs include, without limitation, processing and accounting charges, and late charges that may be imposed on Landlord by the terms of any note secured by a Mortgage covering the Premises. Therefore, in addition to interest, if any amount is not paid when due, a late charge equal to 5% of such amount shall be assessed, provided, however, that on 2 occasions during any calendar year of the Term, Landlord shall give Tenant notice of such late payment and Tenant shall have a period of 5 Business Days thereafter in which to make such payment before any late charge is assessed. Such interest and late charges are separate and cumulative and are in addition to and shall not diminish or represent a substitute for any of Landlord's rights or remedies under any other provision of this Lease.

Section 15.5 Other Rights of Landlord. If Tenant fails to pay any Additional Rent when due, Landlord, in addition to any other right or remedy, shall have the same rights and remedies as in the case of a default by Tenant in the payment of Fixed Rent. If Tenant is in arrears in the payment of Rent, Tenant waives Tenant's right, if any, to designate the items against which any payments made by Tenant are to be credited, and Landlord may apply any payments made by Tenant to any items Landlord sees fit, regardless of any request by Tenant. Landlord reserves the right, without liability to Tenant and without constituting any claim of constructive eviction, to suspend furnishing or rendering to Tenant any property, material, labor, utility or other service, whenever Landlord is obligated to furnish or render the same at the expense of Tenant, in the event that (but only for so long as) Tenant is in arrears in paying Landlord for such items for more than 5 Business Days after notice from Landlord to Tenant demanding the payment of such arrears.

ARTICLE 16

LANDLORD'S RIGHT TO CURE; FEES AND EXPENSES

If Tenant defaults in the performance of its obligations under this Lease, Landlord, without waiving such default, may perform such obligations at Tenant's expense: (a) immediately, and without notice, in the case of emergency or if the default (i) materially interferes with the use by any other tenant of the Building, (ii) materially interferes with the efficient operation of the Building, (iii) results in a violation of any Requirement, or (iv) results or will result in a cancellation of any insurance policy maintained by Landlord, and (b) in any other case if such default continues after 15 days from the date Landlord gives notice of Landlord's intention to perform the defaulted obligation. All costs and expenses incurred by Landlord as a result of any default by Tenant under this Lease or in connection with any such performance by it and all costs and expenses, including reasonable counsel fees and disbursements, incurred by Landlord as a result of any default by Tenant under this Lease or in any action or proceeding (including any unlawful detainer proceeding) brought by Landlord or in which Landlord is a party to enforce any obligation of Tenant under this Lease and/or right of Landlord in or to the Premises, shall be paid by Tenant to Landlord on demand, with interest thereon at the Interest Rate from the date incurred by Landlord. Except as expressly provided to the contrary in this Lease, all costs and expenses which, pursuant to this Lease are incurred by Landlord and payable to Landlord by Tenant, and all charges, amounts and sums payable to Landlord by Tenant for any property, material, labor, utility or other services which, pursuant to this Lease or at the request and for the account of Tenant, are provided, furnished or rendered by Landlord, shall become due and payable by Tenant to Landlord within 10 Business Days after receipt of Landlord's invoice for such amount.

ARTICLE 17

NO REPRESENTATIONS BY LANDLORD; LANDLORD'S APPROVAL

Section 17.1 No Representations. Except as expressly set forth herein, Landlord and Landlord's agents have made no warranties, representations, statements or promises with respect to the Building, the Real Property or the Premises and no rights, easements or licenses are acquired by Tenant by implication or otherwise. Tenant is entering into this Lease after full investigation and is not relying upon any statement or representation made by Landlord not embodied in this Lease.

Section 17.2 No Money Damages. Wherever in this Lease Landlord's consent or approval is required, if Landlord refuses to grant such consent or approval, whether or not Landlord expressly agreed that such consent or approval would not be unreasonably withheld, Tenant shall not make, and Tenant hereby waives, any claim for money damages (including any claim by way of set-off, counterclaim or defense) based upon Tenant's claim or assertion that Landlord unreasonably withheld or delayed its consent or approval. Tenant's sole remedy shall be an action or proceeding to enforce such provision, by specific performance, injunction or declaratory judgment. In no event shall Landlord be liable for, and Tenant, on behalf of itself and all other Tenant Parties, hereby waives any claim for, any indirect, consequential or punitive damages, including loss of profits or business opportunity, arising under or in connection with this Lease.

Section 17.3 Reasonable Efforts. For purposes of this Lease, "reasonable efforts" by Landlord shall not include an obligation to employ contractors or labor at overtime or other premium pay rates or to incur any other overtime costs or additional expenses whatsoever.

ARTICLE 18

END OF TERM

Section 18.1 Expiration. Upon the expiration or other termination of this Lease, Tenant shall quit and surrender the Premises to Landlord vacant, broom clean and in good order and condition, ordinary wear and tear and damage for which Tenant is not responsible under the terms of this Lease excepted, and Tenant shall remove all of Tenant's Property and Tenant's Specialty Alterations as may be required pursuant to **Article 5**.

Section 18.2 Holdover Rent. Landlord and Tenant recognize that Landlord's damages resulting from Tenant's failure to timely surrender possession of the Premises may be substantial, may exceed the amount of the Rent payable hereunder, and will be impossible to accurately measure. Accordingly, if possession of the Premises is not surrendered to Landlord on the Expiration Date or sooner termination of this Lease, in addition to any other rights or remedies Landlord may have hereunder or at law, Tenant shall (a) pay to Landlord for each month (or any portion thereof) during which Tenant holds over in the Premises after the Expiration Date or sooner termination of the Term, a sum equal to two times the Fixed Rent plus two times Tenant's Tax Payment plus two times Tenant's Operating Payment payable under this Lease for the last full calendar month of the Term in the case of any month (or any portion thereof) of any holdover, (b) if Tenant holds over past 10 days after the expiration or earlier termination of the Term, be liable to Landlord for (i) any payment or rent concession which Landlord may be required to make to any tenant obtained by Landlord for all or any part of the Premises (a "New Tenant") in order to induce such New Tenant not to terminate its lease by reason of the holding-over by Tenant, and (ii) the loss of the benefit of the bargain if any New Tenant shall terminate its lease by reason of the holding-over by Tenant, and (c) if Tenant holds over past 10 days after the expiration or earlier termination of the Term, indemnify Landlord against all claims for damages by any New Tenant. No holding-over by Tenant, nor the payment to Landlord of the amounts specified above, shall operate to extend the Term hereof. Nothing herein contained shall be deemed to permit Tenant to retain possession of the Premises after the Expiration Date or sooner termination of this Lease, and no acceptance by Landlord of payments from Tenant after the Expiration Date or sooner termination of this Lease shall be deemed to be other than on account of the amount to be paid by Tenant in accordance with the provisions of this **Section 18.2**.

Section 18.3 Waiver of Stay. Tenant expressly waives, for itself and for any person or entity claiming through or under Tenant, any rights which Tenant or any such person or entity may have under the provisions of Section 2201 of the New York Civil Practice Law and Rules and of any successor Requirement of like import then in force, in connection with any holdover summary proceedings which Landlord may institute to enforce the foregoing provisions of this **Article 18**.

ARTICLE 19

QUIET ENJOYMENT

Provided this Lease is in full force and effect and no Event of Default then exists, Tenant may peaceably and quietly enjoy the Premises without hindrance by Landlord or any person lawfully claiming through or under Landlord, subject to the terms and conditions of this Lease and to all Superior Leases and Mortgages.

ARTICLE 20

NO SURRENDER; NO WAIVER

Section 20.1 No Surrender or Release. No act or thing done by Landlord or Landlord's agents or employees during the Term shall be deemed an acceptance of a surrender of the Premises, and no provision of this Lease shall be deemed to have been waived by Landlord, unless such waiver is in writing and is signed by Landlord.

Section 20.2 No Waiver. The failure of either party to seek redress for violation of, or to insist upon the strict performance of, any covenant or condition of this Lease, or any of the Rules and Regulations, shall not be construed as a waiver or relinquishment for the future performance of such obligations of this Lease or the Rules and Regulations, or of the right to exercise such election but the same shall continue and remain in full force and effect with respect to any subsequent breach, act or omission. The receipt by Landlord of any Rent payable pursuant to this Lease or any other sums with knowledge of the breach of any covenant of this Lease shall not be deemed a waiver of such breach. No payment by Tenant or receipt by Landlord of a lesser amount than the monthly Rent herein stipulated shall be deemed to be other than a payment on account of the earliest stipulated Rent, or as Landlord may elect to apply such payment, nor shall any endorsement or statement on any check or any letter accompanying any check or payment as Rent be deemed an accord and satisfaction, and Landlord may accept such check or payment without prejudice to Landlord's right to recover the balance of such Rent or pursue any other remedy provided in this Lease.

ARTICLE 21

WAIVER OF TRIAL BY JURY; COUNTERCLAIM

Section 21.1 Jury Trial Waiver. LANDLORD AND TENANT HEREBY WAIVE TRIAL BY JURY IN ANY ACTION, PROCEEDING OR COUNTERCLAIM BROUGHT BY EITHER PARTY AGAINST THE OTHER ON ANY MATTERS IN ANY WAY ARISING OUT OF OR CONNECTED WITH THIS LEASE, THE RELATIONSHIP OF LANDLORD AND TENANT, TENANT'S USE OR OCCUPANCY OF THE PREMISES, OR THE ENFORCEMENT OF ANY REMEDY UNDER ANY STATUTE, EMERGENCY OR OTHERWISE.

Section 21.2 Waiver of Counterclaim. If Landlord commences any summary proceeding against Tenant, Tenant will not interpose any counterclaim of any nature or description in any such proceeding (unless failure to interpose such counterclaim would preclude Tenant from asserting in a separate action the claim which is the subject of such

counterclaim), and will not seek to consolidate such proceeding with any other action which may have been or will be brought in any other court by Tenant.

ARTICLE 22

NOTICES

Except as otherwise expressly provided in this Lease, all consents, notices, demands, requests, approvals or other communications given under this Lease shall be in writing and shall be deemed sufficiently given or rendered if delivered by hand (provided a signed receipt is obtained) or if sent by registered or certified mail (return receipt requested) or by a nationally recognized overnight delivery service making receipted deliveries, addressed to Landlord and Tenant as set forth in **Article 1**, and to any Mortgagee or Lessor who shall require copies of notices and whose address is provided to Tenant, or to such other address(es) as Landlord, Tenant or any Mortgagee or Lessor may designate as its new address(es) for such purpose by notice given to the other in accordance with the provisions of this **Article 22**. Any such approval, consent, notice, demand, request or other communication shall be deemed to have been given on the date of receipted delivery, refusal to accept delivery or when delivery is first attempted but cannot be made due to a change of address for which no notice is given or 3 Business Days after it shall have been mailed as provided in this **Article 22**, whichever is earlier.

ARTICLE 23

RULES AND REGULATIONS

All Tenant Parties shall observe and comply with the Rules and Regulations, as supplemented or amended from time to time. Landlord reserves the right, from time to time, to adopt additional Rules and Regulations and to amend the Rules and Regulations then in effect. Nothing contained in this Lease shall impose upon Landlord any obligation to enforce the Rules and Regulations or terms, covenants or conditions in any other lease against any other Building tenant, and Landlord shall not be liable to Tenant for violation of the same by any other tenant, its employees, agents, visitors or licensees, provided that Landlord shall enforce any of the Rules and Regulations against Tenant in a non-discriminatory fashion.

ARTICLE 24

BROKER

Landlord has retained Landlord's Agent as leasing agent in connection with this Lease and Landlord will be solely responsible for any fee that may be payable to Landlord's Agent. Each of Landlord and Tenant represents and warrants to the other that neither it nor its agents have dealt with any broker in connection with this Lease other than Landlord's Agent. Each of Landlord and Tenant shall indemnify, defend, protect and hold the other party harmless from and against any and all Losses which the indemnified party may incur by reason of any claim of or liability to any broker, finder or like agent (other than Landlord's Agent) arising out of any dealings claimed to have occurred between the indemnifying party and the claimant in connection with this Lease, and/or the above representation being false.

ARTICLE 25

INDEMNITY

Section 25.1 Tenant's Indemnity. Tenant shall not do or permit to be done any act or thing upon the Premises or the Building which may subject Landlord to any liability or responsibility for injury, damages to persons or property or to any liability by reason of any violation of any Requirement, and shall exercise such control over the Premises as to fully protect Landlord against any such liability. Tenant shall indemnify, defend, protect and hold harmless each of the Indemnitees from and against any and all Losses, resulting from any claims (i) against the Indemnitees arising from any act, omission or negligence of all Tenant Parties, (ii) except to the extent of Landlord's negligence or willful misconduct, against the Indemnitees arising from any accident, injury or damage whatsoever caused to any person or to the property of any person and occurring in or about the Premises, and (iii) against the Indemnitees resulting from any breach, violation or nonperformance of any covenant, condition or agreement of this Lease on the part of Tenant to be fulfilled, kept, observed or performed.

Section 25.2 Landlord's Indemnity. Landlord shall indemnify, defend and hold harmless Tenant from and against all Losses incurred by Tenant arising from any accident, injury or damage caused to any person or the property of any person in or about the Common Areas (specifically excluding the Premises) to the extent attributable to the negligence or willful misconduct of Landlord or its employees or agents.

Section 25.3 Defense and Settlement. If any claim, action or proceeding is made or brought against any Indemnitee, then upon demand by an Indemnitee, Tenant, at its sole cost and expense, shall resist or defend such claim, action or proceeding in the Indemnitee's name (if necessary), by attorneys approved by the Indemnitee, which approval shall not be unreasonably withheld (attorneys for Tenant's insurer shall be deemed approved for purposes of this **Section 25.3**). Notwithstanding the foregoing, an Indemnitee may retain its own attorneys to participate or assist in defending any claim, action or proceeding involving potential liability in excess of the amount available under Tenant's liability insurance carried under **Section 11.1** for such claim and Tenant shall pay the reasonable fees and disbursements of such attorneys. If Tenant fails to diligently defend or if there is a legal conflict or other conflict of interest, then Landlord may retain separate counsel at Tenant's expense. Notwithstanding anything herein contained to the contrary, Tenant may direct the Indemnitee to settle any claim, suit or other proceeding provided that (a) such settlement shall involve no obligation on the part of the Indemnitee other than the payment of money, (b) any payments to be made pursuant to such settlement shall be paid in full exclusively by Tenant at the time such settlement is reached, (c) such settlement shall not require the Indemnitee to admit any liability, and (d) the Indemnitee shall have received an unconditional release from the other parties to such claim, suit or other proceeding.

ARTICLE 26

MISCELLANEOUS

Section 26.1 Delivery. This Lease shall not be binding upon either party hereto unless and until each party shall have executed and delivered a fully executed copy of this Lease to the other party.

Section 26.2 Transfer of Real Property. Landlord's obligations under this Lease shall not be binding upon the Landlord named herein after the sale, conveyance, assignment or transfer (collectively, a "Transfer") by such Landlord (or upon any subsequent landlord after the Transfer by such subsequent landlord) of its interest in the Building or the Real Property, as the case may be, and in the event of any such Transfer, Landlord (and any such subsequent Landlord) shall be entirely freed and relieved of all covenants and obligations of Landlord hereunder arising from and after the date of Transfer, and the transferee of Landlord's interest (or that of such subsequent Landlord) in the Building or the Real Property, as the case may be, shall be deemed to have assumed all obligations under this Lease arising from and after the date of Transfer.

Section 26.3 Limitation on Liability. The liability of Landlord for Landlord's obligations under this Lease shall be limited to Landlord's interest in the Real Property and Tenant shall not look to any other property or assets of Landlord or the property or assets of any direct or indirect partner, member, manager, shareholder, director, officer, principal, employee or agent of Landlord (collectively, the "Parties") in seeking either to enforce Landlord's obligations under this Lease or to satisfy a judgment for Landlord's failure to perform such obligations; and none of the Parties shall be personally liable for the performance of Landlord's obligations under this Lease.

Section 26.4 Rent. All amounts payable by Tenant to or on behalf of Landlord under this Lease, whether or not expressly denominated Fixed Rent, Tenant's Tax Payment, Tenant's Operating Payment, Additional Rent or Rent, shall constitute rent for the purposes of Section 502(b)(6) of the United States Bankruptcy Code.

Section 26.5 Entire Document. This Lease (including any Schedules and Exhibits referred to herein and all supplementary agreements provided for herein) contains the entire agreement between the parties and all prior negotiations and agreements are merged into this Lease. All of the Schedules and Exhibits attached hereto are incorporated in and made a part of this Lease, provided that in the event of any inconsistency between the terms and provisions of this Lease and the terms and provisions of the Schedules and Exhibits hereto, the terms and provisions of this Lease shall control.

Section 26.6 Governing Law. This Lease shall be governed in all respects by the laws of the State of New York.

Section 26.7 Unenforceability. If any provision of this Lease, or its application to any person or entity or circumstance, shall ever be held to be invalid or unenforceable, then in each such event the remainder of this Lease or the application of such provision to any other person or entity or any other circumstance (other than those as to which it shall be invalid or unenforceable) shall not be thereby affected, and each provision hereof shall remain valid and enforceable to the fullest extent permitted by law.

Section 26.8 Lease Disputes. (a) Tenant agrees that all disputes arising, directly or indirectly, out of or relating to this Lease, and all actions to enforce this Lease, shall be dealt with and adjudicated in the state courts of the State of New York or the federal courts for the Southern District of New York and for that purpose hereby expressly and irrevocably submits

itself to the jurisdiction of such courts. Tenant agrees that so far as is permitted under applicable law, this consent to personal jurisdiction shall be self-operative and no further instrument or action, other than service of process in one of the manners specified in this Lease, or as otherwise permitted by law, shall be necessary in order to confer jurisdiction upon it in any such court.

(b) To the extent that Tenant has or hereafter may acquire any immunity from jurisdiction of any court or from any legal process (whether through service or notice, attachment prior to judgment, attachment in aid of execution, execution or otherwise) with respect to itself or its property, Tenant irrevocably waives such immunity in respect of its obligations under this Lease.

Section 26.9 Landlord's Agent. Unless Landlord delivers notice to Tenant to the contrary, Landlord's Agent is authorized to act as Landlord's agent in connection with the performance of this Lease, and Tenant shall be entitled to rely upon correspondence received from Landlord's Agent. Tenant acknowledges that Landlord's Agent is acting solely as agent for Landlord in connection with the foregoing; and neither Landlord's Agent nor any of its direct or indirect partners, members, managers, officers, shareholders, directors, employees, principals, agents or representatives shall have any liability to Tenant in connection with the performance of this Lease, and Tenant waives any and all claims against any and all of such parties arising out of, or in any way connected with, this Lease, the Building or the Real Property.

Section 26.10 Estoppel. (a) Within 7 days following request from Landlord, any Mortgagee or any Lessor, Tenant shall deliver to Landlord a statement executed and acknowledged by Tenant, in form reasonably satisfactory to Landlord, (i) stating the Commencement Date, the Rent Commencement Date and the Expiration Date, and that this Lease is then in full force and effect and has not been modified (or if modified, setting forth all modifications), (ii) setting forth the date to which the Fixed Rent and any Additional Rent have been paid, together with the amount of monthly Fixed Rent and Additional, Rent then payable, (iii) stating whether or not, to the best of Tenant's knowledge, Landlord is in default under this Lease, and, if Landlord is in default, setting forth the specific nature of all such defaults, (iv) stating the amount of the security, if any, under this Lease, (v) stating whether there are any subleases or assignments affecting the Premises, (vi) stating the address of Tenant to which all notices and communications under the Lease shall be sent, and (vii) responding to any other matters reasonably requested by Landlord, such Mortgagee or such Lessor. Tenant acknowledges that any statement delivered pursuant to this **Section 26.10(a)** may be relied upon by any purchaser or owner of the Real Property or the Building, or all or any portion of Landlord's interest in the Real Property or the Building or any Superior Lease, or by any Mortgagee, or assignee thereof or by any Lessor, or assignee thereof.

(b) From time to time, within 7 days following a request by Tenant, Landlord shall deliver to Tenant a written statement executed and acknowledged by Landlord, in form reasonably acceptable to Tenant and Landlord, (i) stating the Commencement Date, the Rent Commencement Date and the Expiration Date, and that this Lease is then in full force and effect and has not been modified (or, if modified, setting forth all modifications), (ii) setting forth the date to which the Fixed Rent and all Additional Rent have been paid, together with the amount of monthly Fixed Rent, Tenant's Tax Payment and Tenant's Operating Payment then payable, and (iii) stating whether or not, to Landlord's knowledge, Tenant is in default under this Lease, and, if Landlord asserts that Tenant is in default, setting forth the specific nature of all such defaults. Landlord acknowledges that any statement delivered pursuant to this **Section**

26.10(b) may be relied upon by any prospective or actual sublessee of the Premises or assignee of this Lease, or permitted transferee of or successor to Tenant.

Section 26.11 Certain Interpretational Rules. For purposes of this Lease, whenever the words "include", "includes", or "including" are used, they shall be deemed to be followed by the words "without limitation" and, whenever the circumstances or the context requires, the singular shall be construed as the plural, the masculine shall be construed as the feminine and/or the neuter and *vice versa*. This Lease shall be interpreted and enforced without the aid of any canon, custom or rule of law requiring or suggesting construction against the party drafting or causing the drafting of the provision in question. The captions in this Lease are inserted only as a matter of convenience and for reference and in no way define, limit or describe the scope of this Lease or the intent of any provision hereof.

Section 26.12 Parties Bound. The terms, covenants, conditions and agreements contained in this Lease shall bind and inure to the benefit of Landlord and Tenant and, except as otherwise provided in this Lease, to their respective legal representatives, successors, and assigns.

Section 26.13 Memorandum of Lease. This Lease shall not be recorded; however, at Landlord's request, Landlord and Tenant shall promptly execute, acknowledge and deliver a memorandum with respect to this Lease sufficient for recording and Landlord may record the memorandum. Within 10 days after the end of the Term, Tenant shall enter into such documentation as is reasonably required by Landlord to remove the memorandum of record.

Section 26.14 Counterparts. This Lease may be executed in 2 or more counterparts, each of which shall constitute an original, but all of which, when taken together, shall constitute but one instrument.

Section 26.15 Survival. All obligations and liabilities of Landlord or Tenant to the other which accrued before the expiration or other termination of this Lease, and all such obligations and liabilities which by their nature or under the circumstances can only be, or by the provisions of this Lease may be, performed after such expiration or other termination, shall survive the expiration or other termination of this Lease. Without limiting the generality of the foregoing, the rights and obligations of the parties with respect to any indemnity under this Lease, and with respect to any Rent and any other amounts payable under this Lease, shall survive the expiration or other termination of this Lease.

Section 26.16 Inability to Perform. Except as otherwise expressly provided herein, this Lease and the obligation of Tenant to pay Rent and to perform all of the other covenants and agreements of Tenant hereunder shall not be affected, impaired or excused by any Unavoidable Delays. Landlord shall use reasonable efforts to promptly notify Tenant of any Unavoidable Delay which prevents Landlord from fulfilling any of its obligations under this Lease.

Section 26.17 Vault Space. Notwithstanding anything contained in this Lease or indicated on any sketch, blueprint or plan, no vaults, vault space or other space outside the boundaries of the Real Property are included in the Premises. Landlord makes no representation as to the location of the boundaries of the Real Property. All vaults and vault space and all other space outside the boundaries of the Real Property which Tenant may be permitted to use or occupy are to be used or occupied under a revocable license. If any such

license shall be revoked, or if the amount of such space shall be diminished as required by any Governmental Authority or by any public utility company, such revocation, diminution or requisition shall not (a) constitute an actual or constructive eviction, in whole or in part, (b) entitle Tenant to any abatement or diminution of Rent, (c) relieve Tenant from any of its obligations under this Lease, or (d) impose any liability upon Landlord. Any fee, tax or charge imposed by any Governmental Authority for any such vaults, vault space or other space occupied by Tenant shall be paid by Tenant.

Section 26.18 Adjacent Excavation; Shoring. If an excavation shall be made, or shall be authorized to be made, upon land adjacent to the Real Property, Tenant shall, upon notice, afford to the person or entity causing or authorized to cause such excavation license to enter upon the Premises for the purpose of doing such work as such person or entity shall deem necessary to preserve the wall of the Building from injury or damage and to support the same by proper foundations. In connection with such license, Tenant shall have no right to claim any damages or indemnity against Landlord, or diminution or abatement of Rent, provided that Tenant shall continue to have access to the Premises.

Section 26.19 No Development Rights. Tenant acknowledges that it has no rights to any development rights, air rights or comparable rights appurtenant to the Real Property and Tenant consents, without further consideration, to any utilization of such rights by Landlord. Tenant shall promptly execute and deliver any instruments which may be requested by Landlord, including instruments merging zoning lots, evidencing such acknowledgment and consent. The provisions of this **Section 26.19** shall be construed as an express waiver by Tenant of any interest Tenant may have as a "party in interest" (as such term is defined in Section 12-10 of Zoning Lot of the Zoning Resolution of the City of New York) in the Real Property.

ARTICLE 27

SUBSTITUTE SPACE

Section 27.1 At any time and from time to time whether before or after the Commencement Date, Landlord shall have the right to substitute other space in the Building ("**Substitute Space**") for the Premises by notice (a "**Substitution Notice**") given to Tenant designating the space so substituted for the Premises. The Substitute Space shall have a rentable area substantially similar to the Premises shall be located on the 15th floor or higher in the Building and shall have substantially the same configuration as the Premises (i.e., Tenant shall be able to use the Substitute Space in substantially the same manner as it used the Premises). If the Substitute Space is located on the 16th, 17th or 18th floor of the Building, the Substitute Space shall be located on the south side of the Building. Notwithstanding such substitution of space, this Lease and all the terms, provisions, covenants and conditions contained in this Lease shall remain and continue in full force and effect, except that the Premises shall be and be deemed to be the Substitute Space, with the same force and effect as if the Substitute Space were originally specified in this Lease as the Premises demised hereunder.

Section 27.2 In the event of the substitution of space as provided in **Section 27.1** the following provisions (a) through (d) shall apply:

(a) If the Substitute Space has a rentable area greater or less than the Agreed Area of Premises, the Fixed Rent and the Additional Rent payable under this Lease, effective on the date the Substitute Space is available for occupancy by Tenant (the "**Substitution Date**"), shall be increased or decreased appropriately. If the Substitute Space has a rentable area greater than Tenant's Area, the Fixed Rent and the Additional Rent payable under this Lease shall not be changed.

(b) Landlord shall, at Landlord's expense, prepare the Substitute Space in substantially the same manner as the Premises were prepared for Tenant's initial occupancy. Landlord shall have the right to move any millwork, floor covering, cabinet work, and any other decoration as well as telephone lines and any other communication line and other reusable items, from the Premises to the Substitute Space, provided that the removal of any such items shall not materially and adversely affect the use and occupancy of the Premises.

(c) As soon as Landlord has Substantially Completed preparing the Substitute Space as set forth in **Section 27.2(b)**, Tenant, upon 30 days' prior written notice, shall move to the Substitute Space at Landlord's reasonable cost and expense, and upon failure of Tenant so to move to the Substitute Space, Landlord, as Tenant's agent, may remove Tenant from the Premises to the Substitute Space. The failure of Tenant to move to the Substitute Space pursuant to this **Article 27** within 5 days after the expiration of such 30 days' notice shall be an Event of Default, and Tenant shall pay Rent with respect to both the Premises and Substitute Space until Tenant has moved to the Substitute Space.

(d) Promptly after Tenant shall enter into occupancy of the Substitute Space, Landlord shall reimburse Tenant for Tenant's reasonable, direct, out-of-pocket moving expenses (including the cost to replace stationery), unless Landlord moved Tenant into the Substitute Space pursuant to Section (c) above. Upon request from Landlord, Tenant shall supply Landlord with satisfactory evidence of direct out-of-pocket expenses incurred by Tenant in moving from the Premises to the Substitute Space.

Section 27.3 Following any substitution of space pursuant to this **Article 27**, Landlord and Tenant, promptly at the request of either party, shall execute and deliver a supplementary agreement setting forth such substitution of space, the Substitution Date and the change (if any) in the Fixed Rent and Additional Rent.

ARTICLE 28

RENEWAL TERM

Section 28.1 Renewal Term. Tenant shall have the right to renew the Term for all of the Premises for one renewal term of three years (the "**Renewal Term**") commencing on the day after the expiration of the initial Term (the "**Renewal Term Commencement Date**") and ending on the day preceding the third anniversary of the Renewal Term Commencement Date, unless the Renewal Term shall sooner terminate pursuant to any of the terms of this Lease or otherwise. The Renewal Term shall commence only if (a) Tenant notifies Landlord (the "**Exercise Notice**") of Tenant's exercise of such renewal right not later than 15 months prior to the Expiration Date, (b) at the time of the exercise of such right and immediately prior to the Renewal Term Commencement Date, no Event of Default shall have occurred and be continuing hereunder, and (c) the Tenant named herein (i.e., Springer Publishing Company, Inc.) and/or Related Entities occupy at least 80% of the Premises at the time the Exercise

Notice is given. Time is of the essence with respect to the giving of the Exercise Notice. The Renewal Term shall be upon all of the agreements, terms, covenants and conditions of this Lease, except that (w) the Fixed Rent shall be determined as provided in **Section 28.2**, (x) Tenant shall have no further right to renew the Term, (y) the Base Tax Year shall be the Tax Year commencing on the July 1st of the calendar year in which the Renewal Term Commencement Date occurs, and (z) the Base Expense Year shall be the Comparison Year commencing on the January 1st of the calendar year in which the Renewal Term Commencement Date occurs. Upon the commencement of the Renewal Term, (1) the Renewal Term shall be added to and become part of the Term, (2) any reference to "this Lease", to the "Term", the "term of this Lease" or any similar expression shall be deemed to include the Renewal Term, and (3) the expiration of the Renewal Term shall become the Expiration Date. Any termination, cancellation or surrender of the entire interest of Tenant under this Lease at any time during the Term shall terminate any right of renewal of Tenant hereunder.

Section 28.2 Renewal Term Rent. The annual Fixed Rent payable during the Renewal Term shall be equal to the Electrical Inclusion Factor then in effect at the expiration of the initial term of this Lease plus the annual Fair Market Value (as hereinafter defined) as of the Renewal Term Commencement Date. "**Fair Market Value**" shall mean the fair market annual rental value of the Premises as of the Renewal Term Commencement Date for a term equal to the Renewal Term, based on comparable space in the Building, or on comparable space in Comparable Buildings, including all of Landlord's services provided for in this Lease, and with (i) the Premises considered as vacant, and in "as is" condition existing on the Renewal Term Commencement Date, (ii) the Base Tax Year being the Tax Year commencing on the July 1st of the calendar year in which the Renewal Term Commencement Date occurs, and (iii) the Base Expense Year being the Comparison Year commencing on the January 1st of the calendar year in which the Renewal Term Commencement Date occurs. The calculation of Fair Market Value shall also be adjusted to take into account all other relevant factors. Landlord shall advise Tenant (the "**Rent Notice**") of Landlord's determination of Fair Market Value prior to the Renewal Term Commencement Date. If Tenant disputes Landlord's determination of Fair Market Value, the dispute shall be resolved by arbitration as provided in **Section 28.3**. If the Fixed Rent payable during the Renewal Term is not determined prior to the Renewal Term Commencement Date, Tenant shall pay Fixed Rent in an amount equal to the Fair Market Value for the Premises as determined by Landlord (the "**Interim Rent**"). Upon final determination of the Fixed Rent for the Renewal Term, Tenant shall commence paying such Fixed Rent as so determined, and within 10 days after such determination Tenant shall pay any deficiency in prior payments of Fixed Rent or, if the Fixed Rent as so determined shall be less than the Interim Rent, Tenant shall be entitled to a credit against the next succeeding installments of Fixed Rent in an amount equal to the difference between each installment of Interim Rent and the Fixed Rent as so determined which should have been paid for such installment until the total amount of the over payment has been recouped.

Section 28.3 Arbitration. If Tenant disputes Landlord's determination of Fair Market Value pursuant to **Section 28.2**, Tenant shall give notice to Landlord of such dispute within 10 Business Days after delivery of the Rent Notice, and such dispute shall be determined by arbitration in accordance with the then prevailing Expedited Procedures of the Arbitration Rules for the Real Estate Industry of the American Arbitration Association or its successor for arbitration of commercial disputes, except that the rules shall be modified as follows:

- (a) In its demand for arbitration Tenant shall specify the name and address of the person to act as the arbitrator on Tenant's behalf. The arbitrator shall be a real estate broker with at least 10 years full-time commercial brokerage

experience who is familiar with the fair market value of first-class office space in the Borough of Manhattan, City of New York, New York. Failure on the part of Tenant to make the timely and proper demand for such arbitration shall constitute a waiver of the right thereto and the Fixed Rent shall be as set forth in the Rent Notice. Within 10 Business Days after the service of the demand for arbitration, Landlord shall give notice to Tenant specifying the name and address of the person designated by Landlord to act as arbitrator on its behalf, which arbitrator shall be similarly qualified. If Landlord fails to notify Tenant of the appointment of its arbitrator within such 10 Business Day period, and such failure continues for 3 Business Days after Tenant delivers a second notice to Landlord, then the arbitrator appointed by Tenant shall be the arbitrator to determine the Fair Market Value for the Premises.

(b) If two arbitrators are chosen pursuant to **Section 28.3(a)**, the arbitrators so chosen shall meet within 10 Business Days after the second arbitrator is appointed and shall seek to reach agreement on Fair Market Value. If within 20 Business Days after the second arbitrator is appointed the two arbitrators are unable to reach agreement on Fair Market Value then the two arbitrators shall appoint a third arbitrator, who shall be a competent and impartial person with qualifications similar to those required of the first two arbitrators pursuant to **Section 28.3(a)**. If they are unable to agree upon such appointment within 5 Business Days after expiration of such 20 Business Day period, the third arbitrator shall be selected by the parties themselves. If the parties do not agree on the third arbitrator within 5 Business Days after expiration of the foregoing 5 Business Day period, then either party, on behalf of both, may request appointment of such a qualified person by the then president of the Real Estate Board of New York. The third arbitrator shall decide the dispute, if it has not been previously resolved, by following the procedures set forth in **Section 28.3(c)**. Each party shall pay the fees and expenses of its respective arbitrator and both shall share the fees and expenses of the third arbitrator. Attorneys' fees and expenses of counsel and of witnesses for the respective parties shall be paid by the respective party engaging such counsel or calling such witnesses.

(c) Fair Market Value shall be fixed by the third arbitrator in accordance with the following procedures. Concurrently with the appointment of the third arbitrator, each of the arbitrators selected by the parties shall state, in writing, his or her determination of the Fair Market Value supported by the reasons therefor. The third arbitrator shall have the right to consult experts and competent authorities for factual information or evidence pertaining to a determination of Fair Market Value, but any such determination shall be made in the presence of both parties with full right on their part to cross-examine. The third arbitrator shall conduct such hearings and investigations as he or she deem appropriate and shall, within 30 days after being appointed, select which of the two proposed determinations most closely approximates his or her determination of Fair Market Value. The third arbitrator shall have no right to propose a middle ground or any modification of either of the two proposed determinations. The determination he or she chooses as that most closely approximating his or her determination of the Fair Market Value shall constitute the decision of the third arbitrator and shall be final and binding upon the parties. The third arbitrator shall render the decision in writing with counterpart copies to each party. The third arbitrator shall have no power to add to or modify the provisions of this Lease. Promptly following receipt

of the third arbitrator's decision, the parties shall enter into an amendment to this Lease evidencing the extension of the Term for the Renewal Term and confirming the Fixed Rent for the Renewal Term, but the failure of the parties to do so shall not affect the effectiveness of the third arbitrator's determination.

(d) In the event of a failure, refusal or inability of any arbitrator to act, his or her successor shall be appointed by him or her, but in the case of the third arbitrator, his or her successor shall be appointed in the same manner as that set forth herein with respect to the appointment of the original third arbitrator.

IN WITNESS WHEREOF, Landlord and Tenant have executed this Lease as of the day and year first above written.

LANDLORD:

11 WEST 42 LIMITED PARTNERSHIP

By: 11 West 42 Corp., a general partner

By: _____
Name:
Title:

TENANT:

SPRINGER PUBLISHING COMPANY, INC.,

a New York Corporation

By: _____
Its: _____

Tenant's Federal Identification Number:

ACKNOWLEDGMENT

STATE OF NEW YORK)
) s.s.:
COUNTY OF NEW YORK)

On this ____ day of April, in the year 2004 before me, the undersigned, a Notary Public in and said State, personally appeared _____, personally known to me or proved to me on the basis of satisfactory evidence to be the individual(s) whose name(s) is (are) subscribed to the within instrument and acknowledged to me that he/she/they executed the same in his/her/their capacity(ies), and that by his/her/their signature(s) on the instrument, the individual(s), or the person upon behalf of which the individual(s) acted, executed the instrument.

Notary Public

EXHIBIT A

FLOOR PLAN

The floor plan which follows is intended solely to identify the general location of the Premises, and should not be used for any other purpose. All areas, dimensions and locations are approximate, and any physical conditions indicated may not exist as shown.

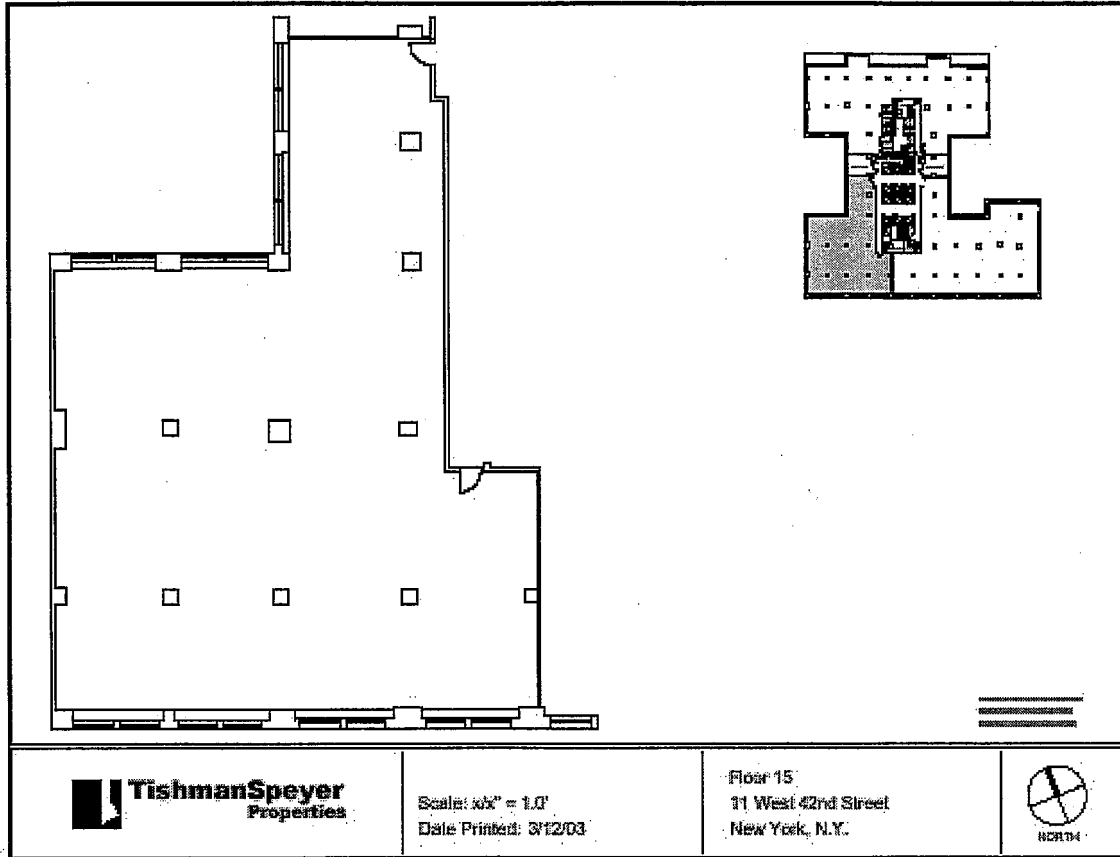

EXHIBIT B
DEFINITIONS

Base Rate: The annual rate of interest publicly announced from time to time by Citibank, N.A., or its successor, in New York, New York as its "base rate" (or such other term as may be used by Citibank, N.A., from time to time, for the rate presently referred to as its "base rate").

Building Systems: The mechanical, electrical, plumbing, sanitary, sprinkler, heating, ventilation and air conditioning, security, life-safety, elevator and other service systems or facilities of the Building up to the point of connection of localized distribution to the Premises (excluding, however, supplemental HVAC systems of tenants, sprinklers and the horizontal distribution systems within and servicing the Premises and by which mechanical, electrical, plumbing, sanitary, heating, ventilating and air conditioning, security, life-safety and other service systems are distributed from the base Building risers, feeders, panelboards, etc. for provision of such services to the Premises).

Business Days: All days, excluding Saturdays, Sundays and Observed Holidays.

Code: The Internal Revenue Code of 1986, as amended, and the regulations promulgated thereunder, as amended.

Common Areas: The lobby, plaza and sidewalk areas and other similar areas of general access and the areas on individual multi-tenant floors in the Building devoted to corridors, elevator lobbies, restrooms, and other similar facilities serving the Premises.

Comparable Buildings: First-class renovated office buildings of comparable age and quality in midtown Manhattan.

Cost Per Kilowatt Hour: (a) The total cost for electricity incurred by Landlord to service the Building during a particular billing period (including energy charges, demand charges, surcharges, time-of-day charges, fuel adjustment charges, rate adjustment charges, taxes, rebates and any other factors used by the public utility company or other provider in computing its charges to Landlord) and/or, if electricity is provided by any electricity generation system owned and operated by Landlord, an amount equal to the total cost which would have been incurred by Landlord had Landlord purchased the electricity generated by Landlord during a particular billing period from a public utility company, during such period, divided by (b) the total kilowatt hours purchased by Landlord to provide electricity to the Building during such period.

Deficiency: The difference between (a) the Fixed Rent and Additional Rent for the period which otherwise would have constituted the unexpired portion of the Term (assuming the Additional Rent for each year thereof to be the same as was payable for the year immediately preceding such termination or re-entry), and (b) the net amount, if any, of rents collected under any reletting effected pursuant to the provisions of the Lease for any part of such period (after first deducting from such rents all expenses incurred by Landlord in connection with the termination of this Lease, Landlord's re-entry upon the Premises and such

reletting, including repossession costs, brokerage commissions, attorneys' fees and disbursements, and alteration costs).

Excluded Expenses: (a) Taxes; (b) franchise or income taxes imposed upon Landlord; (c) mortgage amortization and interest; (d) leasing commissions; (e) the cost of tenant installations and decorations incurred in connection with preparing space for any Building tenant, including workletters and concessions; (f) fixed rent under Superior Leases, if any; (g) management fees to the extent in excess of the greater of (A) 3% of the gross rentals and other revenues collected for the Real Property and (B) fees charged by independent first-class real estate management firms for the management by any of them of other first class properties in the area of the Building; (h) wages, salaries and benefits paid to any persons above the grade of Building Manager and their immediate supervisor; (i) legal and accounting fees relating to (A) disputes with tenants, prospective tenants or other occupants of the Building, (B) disputes with purchasers, prospective purchasers, mortgagees or prospective mortgagees of the Building or the Real Property or any part of either, or (C) negotiations of leases, contracts of sale or mortgages; (j) costs of services provided to other tenants of the Building on a "rent-inclusion" basis which are not provided to Tenant on such basis; (k) costs that are reimbursed out of insurance, warranty or condemnation proceeds, or which are reimbursable by Tenant or other tenants other than pursuant to an expense escalation clause; (l) costs in the nature of penalties or fines; (m) costs for services, supplies or repairs paid to any related entity in excess of costs that would be payable in an "arm's length" or unrelated situation for comparable services, supplies or repairs; (n) allowances, concessions or other costs and expenses of improving or decorating any demised or demisable space in the Building; (o) appraisal, advertising and promotional expenses in connection with leasing of the Building; (p) the costs of installing, operating and maintaining a specialty improvement, including a cafeteria, lodging or private dining facility, or an athletic, luncheon or recreational club unless Tenant is permitted to make use of such facility without additional cost or on a subsidized basis consistent with other users; (q) any costs or expenses (including fines, interest, penalties and legal fees) arising out of Landlord's failure to timely pay Operating Expenses or Taxes; (r) costs incurred in connection with the removal, encapsulation or other treatment of asbestos or any other Hazardous Materials (classified as such on the Effective Date) existing in the Premises as of the date hereof; (s) the cost of capital improvements other than those expressly included in Operating Expenses pursuant to **Section 7.1**; (t) the cost of acquisition or leasing of sculptures, paintings or other objects of fine art in the Building other than the cost of replacing, maintaining, providing security for and insuring such art; (u) costs associated with Landlord's voluntary political contributions, voluntary civil contributions or voluntary charitable contributions; and (v) accounting fees except such fees as are incurred in connection with the ownership, operation, maintenance and management of the Building.

Governmental Authority: The United States of America, the City of New York, County of New York, or State of New York, or any political subdivision, agency, department, commission, board, bureau or instrumentality of any of the foregoing, now existing or hereafter created, having jurisdiction over the Real Property.

Hazardous Materials: Any substances, materials or wastes currently or in the future deemed or defined in any Requirement as "hazardous substances," "toxic substances," "contaminants," "pollutants" or words of similar import.

HVAC System: The Building System designed to provide heating, ventilation and air conditioning.

Indemnitees: Landlord, Landlord's Agent, each Mortgagee and Lessor, and each of their respective direct and indirect partners, officers, shareholders, directors, members, managers, trustees, beneficiaries, employees, principals, contractors, servants, agents, and representatives.

Lessor: A lessor under a Superior Lease.

Losses: Any and all losses, liabilities, damages, claims, judgments, fines, suits, demands, costs, interest and expenses of any kind or nature (including reasonable attorneys' fees and disbursements) incurred in connection with any claim, proceeding or judgment and the defense thereof, and including all costs of repairing any damage to the Premises or the Building or the appurtenances of any of the foregoing to which a particular indemnity and hold harmless agreement applies.

Mortgage(s): Any mortgage, trust indenture or other financing document which may now or hereafter affect the Premises, the Real Property, the Building or any Superior Lease and the leasehold interest created thereby, and all renewals, extensions, supplements, amendments, modifications, consolidations and replacements thereof or thereto, substitutions therefor, and advances made thereunder.

Mortgagee(s): Any mortgagee, trustee or other holder of a Mortgage.

Observed Holidays: New Years Day, Memorial Day, Independence Day, Labor Day, Thanksgiving Day and Christmas Day plus days observed by the State of New York, the City of New York and the labor unions servicing the Building as holidays.

Ordinary Business Hours: 8:00 a.m. to 6:00 p.m. on Business Days.

Prohibited Use: Any use or occupancy of the Premises that in Landlord's reasonable judgment would: (a) cause damage to the Building or any equipment, facilities or other systems therein; (b) impair the appearance of the Building; (c) interfere with the efficient and economical maintenance, operation and repair of the Premises or the Building or the equipment, facilities or systems thereof; (d) adversely affect any service provided to, and/or the use and occupancy by, any Building tenant or occupants; (e) violate the certificate of occupancy issued for the Premises or the Building; (f) materially and adversely affect the first-class image of the Building or (g) result in protests or civil disorder or commotions at, or other disruptions of the normal business activities in, the Building. Prohibited Use also includes the use of any part of the Premises for: (i) a restaurant or bar; (ii) the preparation, consumption, storage, manufacture or sale of food or beverages (except in connection with vending machines (provided that each machine, where necessary, shall have a waterproof pan thereunder and be connected to a drain) and/or warming kitchens installed for the use of Tenant's employees only), liquor, tobacco or drugs; (iii) the business of photocopying, multilith or offset printing (except photocopying in connection with Tenant's own business); (iv) a school or classroom; (v) lodging or sleeping; (vi) the operation of retail facilities (meaning a business whose primary patronage arises from the generalized solicitation of the general public to visit Tenant's offices in person without a prior appointment) of a savings and loan association or retail facilities of any financial, lending, securities brokerage or investment activity; (vii) a payroll office; (viii) a barber, beauty or manicure shop; (ix) an employment agency or similar enterprise; (x) offices of any Governmental Authority, any foreign government, the United Nations, or any agency or department of the foregoing; (xi) the manufacture, retail sale, storage of merchandise or auction of merchandise, goods or property of any kind to the general public which could reasonably be

expected to create a volume of pedestrian traffic substantially in excess of that normally encountered in the Premises; (xii) the rendering of medical, dental or other therapeutic or diagnostic services; or (xiii) any illegal purposes or any activity constituting a nuisance.

Requirements: All present and future laws, rules, orders, ordinances, regulations, statutes, requirements, codes and executive orders, extraordinary and ordinary of (i) all Governmental Authorities, including the Americans With Disabilities Act, 42 U.S.C. §12101 (et seq.), New York City Local Law 58 of 1987, and any law of like import, and all rules, regulations and government orders with respect thereto, and any of the foregoing relating to Hazardous Materials, environmental matters, public health and safety matters, and landmarks protection, (ii) any applicable fire rating bureau or other body exercising similar functions, affecting the Real Property or the maintenance, use or occupation thereof, or any street, avenue or sidewalk comprising a part of or in front thereof or any vault in or under the same, (iii) all requirements of all insurance bodies affecting the Premises, and (iv) utility service providers.

Rules and Regulations: The rules and regulations annexed to and made a part of this Lease as **Exhibit F**, as they may be modified from time to time by Landlord.

Specialty Alterations: Alterations which are not standard office installations such as kitchens, executive bathrooms, raised computer floors, computer room installations, supplemental HVAC equipment, safe deposit boxes, vaults, libraries or file rooms requiring reinforcement of floors, internal staircases, slab penetrations, conveyors, dumbwaiters, and other Alterations of a similar character. All Specialty Alterations are Above-Building Standard Installations.

Substantial Completion: As to any construction performed by any party, "**Substantial Completion**" or "**Substantially Completed**" means that such work has been completed, as reasonably determined by Landlord's architect, in accordance with (a) the provisions of this Lease applicable thereto, (b) the plans and specifications for such work, (c) all applicable Requirements, and (d) a good and workmanlike manner, except for minor details of construction, decoration and mechanical adjustments, if any, the noncompletion of which does not materially interfere with Tenant's use of the Premises or which in accordance with good construction practice should be completed after the completion of other work in the Premises or the Building ("**Punch List Items**").

Superior Lease(s): Any ground or underlying lease of the Real Property or any part thereof heretofore or hereafter made by Landlord and all renewals, extensions, supplements, amendments, modifications, consolidations, and replacements thereof.

Tenant Delay: Any delay which results from any act or omission of any Tenant Party, including delays due to changes in or additions to, or interference with any work to be done by Landlord, or delays by Tenant in submission of information approving working drawings or estimates or giving authorizations or approvals.

Tenant Party: Tenant and any subtenants and occupants of the Premises and their respective agents, contractors, subcontractors, employees, invitees or licensees.

Tenant's Property: Tenant's movable fixtures and movable partitions, telephone and other equipment, computer systems, trade fixtures, furniture, furnishings, and other items of personal property which are removable without material damage to the Building.

Unavoidable Delays: Landlord's inability to fulfill or delay in fulfilling any of its obligations under this Lease expressly or impliedly to be performed by Landlord or Landlord's inability to make or delay in making any repairs, additions, alterations, improvements or decorations or Landlord's inability to supply or delay in supplying any equipment or fixtures, if Landlord's inability or delay is due to or arises by reason of strikes, labor troubles or by accident, or by any cause whatsoever beyond Landlord's reasonable control, including governmental preemption in connection with a national emergency, Requirements or shortages, or unavailability of labor, fuel, steam, water, electricity or materials, or delays caused by Tenant or other tenants, mechanical breakdown, acts of God, enemy action, civil commotion, fire or other casualty.

EXHIBIT C

WORKLETTER

1. General.

1.1 The purpose of this Workletter is to set forth (i) how the interior improvements to the Premises which Tenant desires to have completed in connection with Tenant's initial occupancy of the Premises ("**Landlords Work**") are to be constructed, (ii) who will do the construction of Landlord's Work, and (iii) who will pay for the construction of Landlord's Work.

1.2 Except as defined in this Workletter to the contrary, all capitalized terms used in this Workletter have the same meanings as the defined terms in the Lease.

1.3 The terms, conditions and requirements of the Lease, except where clearly inconsistent or inapplicable to this Workletter, are incorporated into this Workletter.

1.4 Attached hereto as Schedule A to this Workletter are plans and specifications for Landlord's Work, together with any notes attached thereto (collectively, the "**Drawings**") prepared by Group 3 (the "**Architect**"). Tenant hereby approves the Drawings for all purposes of the Lease and this Workletter.

2. Procedures.

2.1 Neither the preparation of the Drawings and related construction drawings and specifications prepared in connection therewith by the Architect, nor the review or approval thereof by Landlord, shall constitute a representation or warranty by Landlord that any of the Drawings and related construction drawings and specifications prepared in connection therewith are complete or suitable for their intended purpose and Tenant expressly agrees that Landlord assumes no responsibility or liability whatsoever to Tenant or to any other person or entity for such suitability.

2.2 As soon as reasonably practicable following the execution and delivery of the Lease, Landlord shall instruct the general contractor engaged by Landlord to commence the construction of Landlord's Work in accordance with sound construction industry practice and procedure, Requirements and the Drawings and related construction drawings and specifications prepared in connection therewith, and subject to the obtaining of all permits and approvals of Governmental Authorities required under applicable Requirements. Except as otherwise provided in the Workletter, Landlord shall perform Landlord's Work in accordance with all applicable Requirements at Landlord's sole cost and expense.

2.3 The executive lavatories and lighting depicted in the Drawings are above Building standard work and materials. Tenant shall pay the full cost of providing and installing such executive lavatories and the additional incremental cost (as determined by Landlord) of providing and installing such lighting, together with the costs of all additional filing fees and permits required by any Governmental Authority and incurred by Landlord in connection with such work and all sales taxes imposed thereon. Tenant shall pay such costs to Landlord within 10 days after demand therefor. Any failure by Tenant to pay, or delay in paying, such costs shall constitute a Tenant Delay and, at Landlord's option, an Event of Default.

3. **Change Orders.** If Tenant requests any changes to the Drawings, Landlord shall not unreasonably withhold its consent to any such changes, provided the changes do not adversely affect the Building's structure, any asbestos-containing materials, any of the Building Systems, or the appearance or value of the Building (any such change consented to by Landlord is hereinafter referred to as a "**Change Order**"). If any Change Order increases the cost of constructing Landlord's Work, Tenant shall bear such cost, and shall pay to Landlord, on demand, the sum of (i) the amount by which (A) the actual costs incurred by Landlord to construct Landlord's Work, as modified by the Change Order, exceed (B) the actual costs which would have been incurred by Landlord to construct Landlord's Work in the absence of such Change Order (the "**Differential**"), (ii) any cancellation fees, reshipping charges or any other similar costs incurred by Landlord as a result of the Change Order, and (iii) an amount equal to 10% of the Differential, to compensate Landlord for its time and effort in connection with the Change Order. If any Change Order delays Landlord's completion of Landlord's Work, then such delay shall constitute a Tenant Delay. Any other actions of Tenant, or inaction by Tenant (including the failure by Tenant to timely pay for the cost of any Change Order) which delay Landlord in completing Landlord's Work shall also constitute Tenant Delays. Whenever possible and practicable, Landlord will use the items and materials designated in the Drawings for the construction of Landlord's Work; provided, however, that if Landlord determines in its reasonable judgment that it is not practical or efficient to use such materials, Landlord shall have the right to substitute items and materials of comparable quality and utility. If the Substantial Completion Date shall be delayed by reason of Tenant Delay, the Premises shall be deemed Substantially Completed for the purposes of determining the Rent Commencement Date as of the date that the Premises would have been Substantially Completed but for any such Tenant Delay, as determined by Landlord in its reasonable discretion. In addition, Tenant shall pay to Landlord a sum equal to any additional cost to Landlord in completing Landlord's Work resulting from any Tenant Delay.

4. **Entry by Tenant and Its Agents; Designation of Tenant's Construction Agent.**

4.1 Except as hereinafter provided, neither Tenant nor its agents, employees, invitees or independent contractors shall enter the Premises during the performance of Landlord's Work. Tenant shall designate an authorized agent ("**Tenant's Construction Agent**") prior to 10 days after the date of this Lease for the purpose of submitting to Landlord and authorizing any Change Orders and for the purpose of consulting with Landlord as to any and all aspects of Landlord's Work. Tenant's Construction Agent shall have the right to inspect the Premises during the course of Landlord's Work provided Tenant's Construction Agent shall make a prior appointment with Landlord and/or its contractor at a mutually convenient time.

4.2 If Tenant shall enter upon the Premises or any other part of the Building prior to the completion of Landlord's Work, Tenant shall indemnify and save Landlord harmless from and against any and all Losses arising from or claimed to arise as a result of (i) any act, neglect or failure to act of Tenant or anyone entering the Premises or Building with Tenant's permission, or (ii) any other reason whatsoever arising out of Tenant's entry upon the Premises or Building.

5. **Substantial Completion.**

5.1 Landlord shall notify Tenant of the anticipated date of Substantial Completion of Landlord's Work (the "**Substantial Completion Date**") in a notice given at least five 5 days prior to the Substantial Completion Date stated therein. Landlord and Tenant shall

thereupon set a mutually convenient time on or prior to such date for Tenant's Construction Agent, the Architect, Landlord and Landlord's contractor to inspect the Premises and Landlord's Work, at which time Tenant's Construction Agent shall prepare and submit to Landlord a list of Punch List items, if any, to be completed. Upon completion of the inspection, Tenant's Construction Agent shall prepare a list of Punch-List Items to be completed. Landlord shall complete the Punch List Items within 30 days thereafter.

5.2 Landlord's Work (unless otherwise specifically provided in the Drawings) shall be of material, manufacture, design, capacity, quality, finish and color of the standard adopted by Landlord for the Building and, where quantities are specified in the Drawings or otherwise, such quantities shall include any existing installations to the extent usable and used in the performance of Landlord's Work.

6. Miscellaneous.

6.1 Except as expressly set forth herein, Landlord has no other agreement with Tenant and Landlord has no other obligation to do any other work or pay any amounts with respect to the Premises. Any other work in the Premises which may be permitted by Landlord pursuant to the terms and conditions of the Lease shall be done at Tenant's sole cost and expense and in accordance with the terms and conditions of the Lease.

6.2 This Workletter shall not be deemed applicable to any additional space added to the original Premises at any time or from time to time, whether by any options under the Lease or otherwise, or to any portion of the original Premises or any additions thereto in the event of a renewal or extension of the initial term of the Lease, whether by any options under the Lease or otherwise, unless expressly so provided in the Lease or any amendment or supplement thereto.

6.3 The failure by Tenant to pay any monies due Landlord pursuant to this Workletter within five days of the date due shall be deemed an Event of Default under the Lease for which Landlord shall be entitled to exercise all remedies available to Landlord for nonpayment of Rent and Landlord, may, if it so elects, discontinue construction of Landlord's Work until all such sums are paid and Tenant has otherwise cured such Event of Default (and any delay in the performance of Landlord's Work resulting therefrom shall be deemed to be a Tenant Delay). All late payments shall bear interest at the Interest Rate pursuant to **Section 15.4** of the Lease.

6.4 Landlord and its employees, contractors and agents shall have access to the Premises for the performance of Punch List Items and for the storage of materials required in connection therewith. There shall be no Rent abatement or allowance to Tenant for a diminution of rental value, no actual or constructive eviction of Tenant, in whole or in part, no relief from any of Tenant's other obligations under the Lease, and no liability on the part of Landlord, by reason of inconvenience, annoyance or injury to business arising from the performance of Punch List Items or the storage of any materials in connection therewith.

SCHEDULE A

Drawings

See Attached

EXHIBIT D

DESIGN STANDARDS

The Building HVAC System serving the Premises is designed to maintain average temperatures within the Premises during the hours of 8:00 a.m. to 6:00 p.m. on Business Days of (i) not less than 68 degrees F. during the heating season when the outdoor temperature is 5 degree F. or more and (ii) not more than 78 degrees F. and 50% humidity + 5% during the cooling season, when the outdoor temperatures are at 89 degrees F. dry bulb and 73 degrees F. wet bulb, with, in the case of clauses (i) and (ii), a population load per floor of not more than one person per 100 square feet of useable area, other than in dining and other special use areas per floor for all purposes, and shades fully drawn and closed, including lighting and power, and to provide at least .15 CFM of outside ventilation per square foot of rentable area. Use of the Premises, or any part thereof, in a manner exceeding the foregoing design conditions or rearrangement of partitioning after the initial preparation of the Premises which interferes with normal operation of the air-conditioning service in the Premises may require changes in the air-conditioning system serving the Premises.

EXHIBIT E
CLEANING SPECIFICATIONS

GENERAL CLEANING

NIGHTLY

General Offices:

1. All hard surfaced flooring to be swept using approved dustdown preparation.
2. Carpet sweep all carpets, moving only light furniture (desks, file cabinets, etc. not to be moved).
3. Hand dust and wipe clean all furniture, fixtures and window sills.
4. Empty all waste receptacles and remove wastepaper.
5. Wash clean all Building water fountains and coolers.
6. Sweep all private stairways.

Lavatories:

1. Sweep and wash all floors, using proper disinfectants.
2. Wash and polish all mirrors, shelves, bright work and enameled surfaces.
3. Wash and disinfect all basins, bowls and urinals.
4. Wash all toilet seats.
5. Hand dust and clean all partitions, tile walls, dispensers and receptacles in lavatories and restrooms.
6. Empty paper receptacles, fill receptacles and remove wastepaper.
7. Fill toilet tissue holders.
8. Empty and clean sanitary disposal receptacles.

WEEKLY

1. Vacuum all carpeting and rugs.
2. Dust all door louvers and other ventilating louvers within a person's normal reach.
3. Wipe clean all brass and other bright work.

QUARTERLY

High dust premises complete including the following:

1. Dust all pictures, frames, charts, graphs and similar wall hangings not reached in nightly cleaning.
2. Dust all vertical surfaces, such as walls, partitions, doors, door frames and other surfaces not reached in nightly cleaning.
3. Dust all venetian blinds.
4. Wash all windows.

EXHIBIT F

RULES AND REGULATIONS

1. Nothing shall be attached to the outside walls of the Building. Other than Building standard blinds, no curtains, blinds, shades, screens or other obstructions shall be attached to or hung in or used in connection with any exterior window or entry door of the Premises, without the prior consent of Landlord.

2. No sign, advertisement, notice or other lettering visible from the exterior of the Premises shall be exhibited, inscribed, painted or affixed to any part of the Premises without the prior written consent of Landlord. All lettering on doors shall be inscribed, painted or affixed in a size, color and style acceptable to Landlord.

3. The grills, louvers, skylights, windows and doors that reflect or admit light and/or air into the Premises or Common Areas shall not be covered or obstructed by Tenant, nor shall any articles be placed on the window sills, radiators or convectors.

4. Landlord shall have the right to prohibit any advertising by any Tenant which, in Landlord's opinion, tends to impair the reputation of the Building, and upon written notice from Landlord, Tenant shall refrain from or discontinue such advertising.

5. The Common Areas shall not be obstructed or encumbered by any Tenant or used for any purposes other than ingress of egress to and from the Premises and for delivery of merchandise and equipment in a prompt and efficient manner, using elevators and passageways designated for such delivery by Landlord.

6. Except in those areas designated by Tenant as "security areas," all locks or bolts of any kind shall be operable by the Building's Master Key. No locks shall be placed upon any of the doors or windows by Tenant, nor shall any changes be made in locks or the mechanism thereof which shall make such locks inoperable by the Building's Master Key. Tenant shall, upon the termination of its Lease, deliver to Landlord all keys of stores, offices and lavatories, either furnished to or otherwise procured by Tenant and in the event of the loss of any keys furnished by Landlord, Tenant shall pay to Landlord the cost thereof.

7. Tenant shall keep the entrance door to the Premises closed at all times.

8. All movement in or out of any freight, furniture, boxes, crates or any other large object or matter of any description must take place during such times and in such elevators as Landlord may prescribe. Landlord reserves the right to inspect all articles to be brought into the Building and to exclude from the Building all articles which violate any of these Rules and Regulations or the Lease. Landlord may require that any person leaving the public areas of the Building with any article to submit a pass, signed by an authorized person, listing each article being removed, but the establishment and enforcement of such requirement shall not impose any responsibility on Landlord for the protection of any Tenant against the removal of property from the Premises.

9. All hand trucks shall be equipped with rubber tires, side guards and such other safeguards as Landlord may require.

10. No Tenant Party shall be permitted to have access to the Building's roof, mechanical, electrical or telephone rooms without permission from Landlord.

11. Tenant shall not permit or suffer the Premises to be occupied or used in a manner offensive or objectionable to Landlord or other occupants of the Building by reason of noise, odors, vibrations or interfere in any way with other tenants or those having business therein.

12. Tenant shall not employ any person or persons other than the janitor of Landlord for the purpose of cleaning the Premises, unless otherwise agreed to by Landlord. Tenant shall not cause any unnecessary labor by reason of such Tenant's carelessness or indifference in the preservation of good order and cleanliness.

13. Tenant shall store all its trash and recyclables within its Premises. No material shall be disposed of which may result in a violation of any Requirement. All refuse disposal shall be made only through entry ways and elevators provided for such purposes and at such times as Landlord shall designate. Tenant shall use the Building's hauler.

14. Tenant shall not deface any part of the Building. No boring, cutting or stringing of wires shall be permitted, except with prior consent of Landlord, and as Landlord may direct.

15. The water and wash closets, electrical closets, mechanical rooms, fire stairs and other plumbing fixtures shall not be used for any purposes other than those for which they were constructed and no sweepings, rubbish, rags, acids or other substances shall be deposited therein. All damages resulting from any misuse of the fixtures shall be borne by Tenant where a Tenant Party caused the same.

16. Tenant, before closing and leaving the Premises at any time, shall see that all lights, water faucets, etc. are turned off. All entrance doors in the Premises shall be kept locked by Tenant when the Premises are not in use.

17. No bicycles, in-line roller skates, vehicles or animals of any kind (except for seeing eye dogs) shall be brought into or kept by any Tenant in or about the Premises or the Building.

18. Canvassing or soliciting in the Building is prohibited.

19. Employees of Landlord or Landlord's Agent shall not perform any work or do anything outside of the regular duties, unless under special instructions from the office of Landlord or in response to any emergency condition.

20. Tenant is responsible for the delivery and pick up of all mail from the United States Post Office.

21. Landlord reserves the right to exclude from the Building during other than Ordinary Business Hours all persons who do not present a valid Building pass. Tenant shall be responsible for all persons for whom a pass shall be issued at the request of Tenant and shall be liable to Landlord for all acts of such persons.

22. Landlord shall not be responsible to Tenant or to any other person or entity for the non-observance or violation of these Rules and Regulations by any other tenant or other person or entity. Tenant shall be deemed to have read these Rules and Regulations and to have agreed to abide by them as a condition to its occupancy of the Premises.

23. The review/alteration of Tenant drawings and/or specifications by Landlord's Agent and any of its representatives is not intended to verify Tenant's engineering or design requirements and/or solutions. The review/alteration is performed to determine compatibility with the Building Systems and lease conditions. Tenant renovations must adhere to the Building's applicable Standard Operating Procedures and be compatible with all Building Systems.